

Series CERAM™, size 4

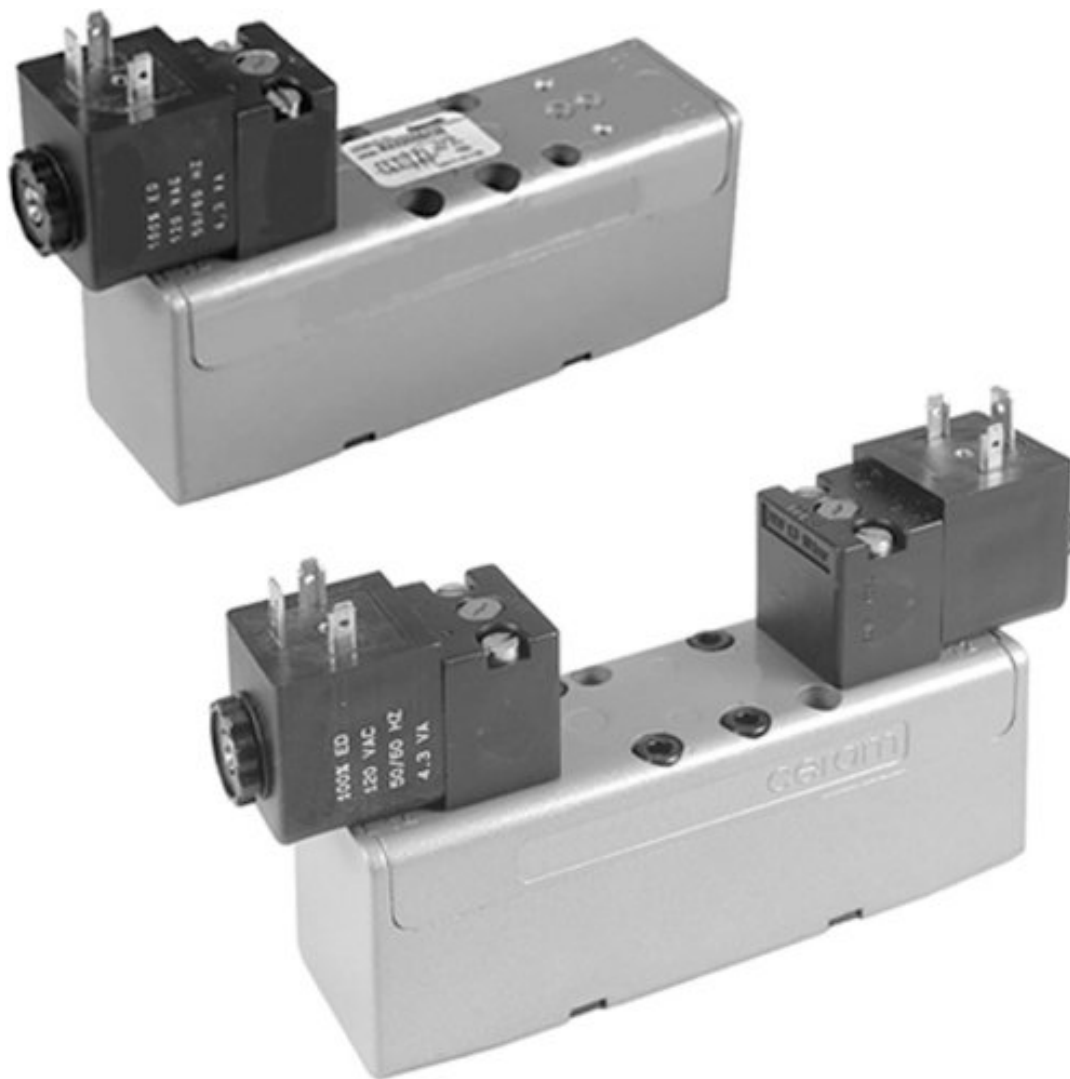

AVENTICS™ Series CERAM™, size 4

















5/2-directional valve, Series CERAM™, size 4

- 5/2
- Qn = 7500 l/min
- Pilot valve width : 30 mm
- Plate connection
- Electrical connection : Plug, EN 175301-803, form A
- Can be assembled into blocks
- Manual override : with detent, without detent
- single solenoid
- With air spring return
- Pilot : Internal External

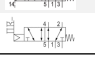

Activation	Electrically
Sealing principle	Ceramic
Blocking principle	Single base plate principle
Standards	ISO 5599-1, ISO 4
Working pressure min./max.	0 ... 10.3 bar
Control pressure min./max.	See table below
Ambient temperature min./max.	-15 ... 66 °C
Medium temperature min./max.	-15 ... 66 °C
Medium	Compressed air
Nominal flow Qn	7500 l/min
Compressed air connection	according to ISO 5599-1
Protection class according to NEMA	NEMA 4
Weight	See table below

Technical data

Part No.		MO	Compressed air connection		Operational voltage
			Pilot Exhaust		
R432006325			Base plate ISO 5599-1		12 V
R432006326			Base plate ISO 5599-1		24 V
R432030177			Base plate ISO 5599-1		-
R432006321			Base plate ISO 5599-1		-
R432006323			Base plate ISO 5599-1		-
R432002464			Base plate ISO 5599-1		-
R432002467			Base plate ISO 5599-1		-

Part No.	Operational voltage		Voltage tolerance
	AC 50 Hz	AC 60 Hz	
R432006325	-	-	-10% / +10%
R432006326	-	-	-10% / +10%
R432030177	24 V	24 V	-
R432006321	110 V	120 V	-
R432006323	220 V	240 V	-
R432002464	-	-	-
R432002467	-	-	-

Part No.	Voltage tolerance	Voltage tolerance	Power consumption	Holding power
	AC 50 Hz	AC 60 Hz	DC	AC 50 Hz
R432006325	-	-	2.7 W	-
R432006326	-	-	2.7 W	-
R432030177	-10% / +10%	-10% / +10%	-	3.7 VA
R432006321	-10% / +10%	-10% / +10%	-	3.7 VA
R432006323	-10% / +10%	-10% / +10%	-	3.7 VA
R432002464	-	-	-	-
R432002467	-	-	-	-

Part No.	Holding power	Switch-on power	Switch-on power	Pilot	Control pressure min./max.
	AC 60 Hz	AC 50 Hz	AC 60 Hz		
R432006325	-	-	-	Internal	2.5 ... 10.3 bar
R432006326	-	-	-	Internal	2.5 ... 10.3 bar
R432030177	3.7 VA	6.4 VA	6.4 VA	Internal	2.5 ... 10.3 bar
R432006321	3.7 VA	6.4 VA	6.4 VA	Internal	2.5 ... 10.3 bar
R432006323	3.7 VA	6.7 VA	6.7 VA	Internal	2.5 ... 10.3 bar
R432002464	-	-	-	External	-0.8 ... 10.3 bar
R432002467	-	-	-	Internal	2.5 ... 10.3 bar

Part No.	Valve plug connector	basic valve with electrical connector
R432006325	Without valve plug connector	-
R432006326	Without valve plug connector	-
R432030177	Without valve plug connector	-
R432006321	Without valve plug connector	-
R432006323	Without valve plug connector	-

Part No.	Valve plug connector	basic valve with electrical connector
R432002464	Without valve plug connector	Basic valve without coil
R432002467	Without valve plug connector	Basic valve without coil

Part No.	Mounting screw	Weight
R432006325	M8 with hexagon socket	2.38 kg
R432006326	M8 with hexagon socket	2.38 kg
R432030177	M8 with hexagon socket	2.38 kg
R432006321	M8 with hexagon socket	2.38 kg
R432006323	M8 with hexagon socket	2.38 kg
R432002464	M5 with hexagon socket	2.09 kg
R432002467	M8 with hexagon socket	2.09 kg

Nominal flow Q_n at 6 bar and $\Delta p = 1$ bar

MO = Manual override

Technical information

The min. control pressure must be adhered to, since otherwise faulty switching and valve failure may result!

The pressure dew point must be at least 15 °C under ambient and medium temperature and may not exceed 3 °C .

The oil content of compressed air must remain constant during the life cycle.

Use only the approved oils from AVENTICS. Further information can be found in the "Technical information" document (available in the MediaCentre).

Technical information

Material

Housing	Die-cast aluminum, painted gray
---------	---------------------------------

Dimensions

Dimensions in inches

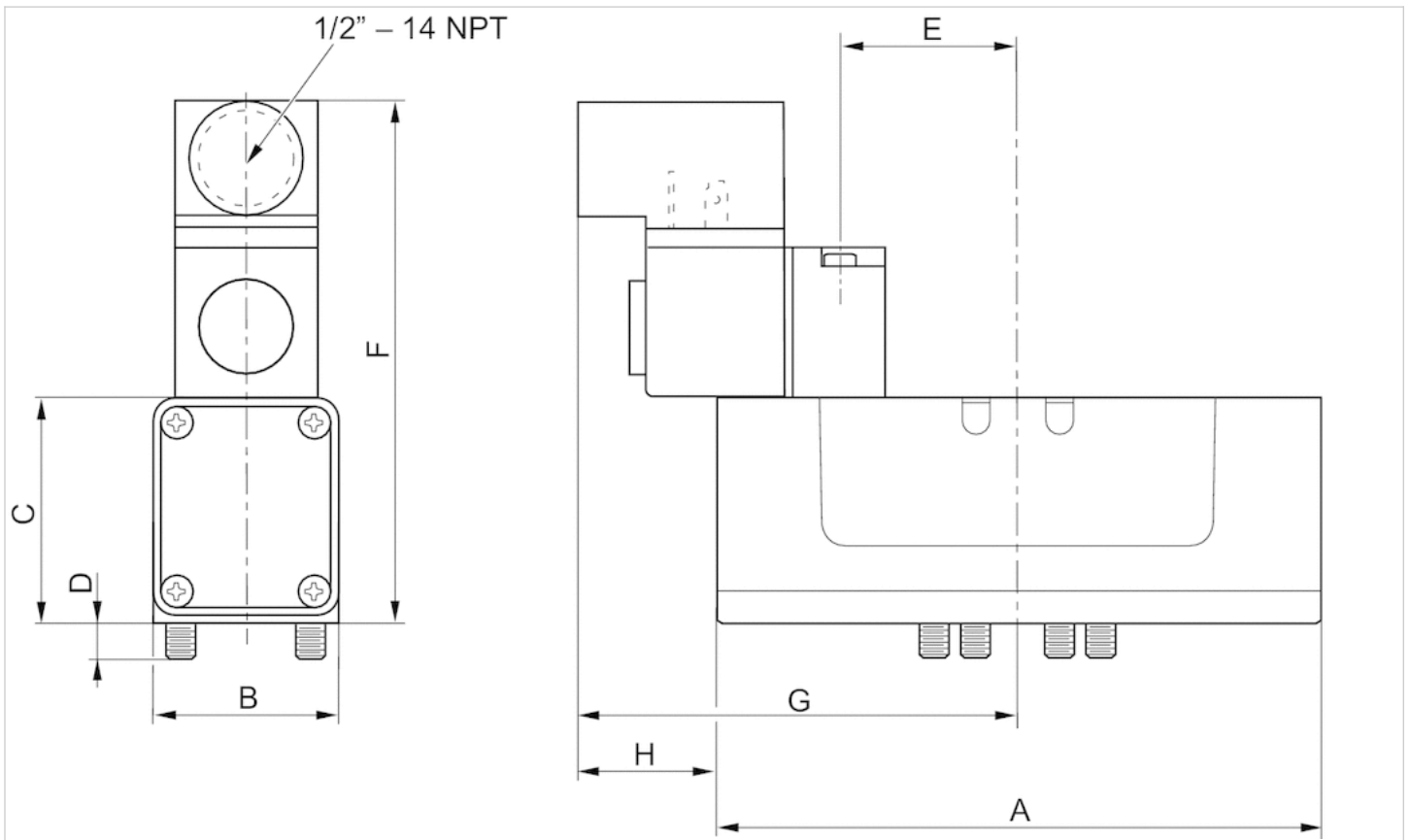

Dimensions in inches

Part No.	A	B	C	D	E	F	G	H
R432006325	8.62	3.09	2.89	0.41	1.62	5.23	6.65	0.68
R432006326	8.62	3.09	2.89	0.41	1.62	5.23	6.65	0.68
R432030177	8.62	3.09	2.89	0.41	1.62	5.23	6.65	0.68
R432006321	8.62	3.09	2.89	0.41	1.62	5.23	6.65	0.68
R432006323	8.62	3.09	2.89	0.41	1.62	5.23	6.65	0.68
-	-	-	-	-	-	-	-	-
R432002467	8.62	3.09	2.89	0.41	1.62	5.23	6.65	0.68

5/2-directional valve, Series CERAM™, size 4

- 5/2
- Qn = 7500 l/min
- Pilot valve width : 30 mm CNOMO
- Plate connection
- Electrical connection : Plug, EN 175301-803, form A
- Can be assembled into blocks
- Manual override : with detent, without detent
- single solenoid
- With air spring return
- Pilot : Internal External



Activation	Electrically
Sealing principle	Ceramic
Blocking principle	Single base plate principle
Standards	ISO 5599-1, ISO 4
Working pressure min./max.	0 ... 10.3 bar
Control pressure min./max.	2.5 ... 10.3 bar
Ambient temperature min./max.	-15 ... 66 °C
Medium temperature min./max.	-15 ... 66 °C
Medium	Compressed air
Nominal flow Qn	7500 l/min
Compressed air connection	according to ISO 5599-1
Protection class according to NEMA	NEMA 4
mounting screws	M8 with hexagon socket
Weight	See table below

Technical data

Part No.	MO	Compressed air connection		Operational voltage
		Pilot Exhaust		DC
R432030378		Base plate ISO 5599-1		12 V
R432006327		Base plate ISO 5599-1		24 V
R432030352		Base plate ISO 5599-1		-
R432006322		Base plate ISO 5599-1		-
R432006324		Base plate ISO 5599-1		-
R432002465		Base plate ISO 5599-1		-
R432002468		Base plate ISO 5599-1		-

Part No.	Operational voltage		Voltage tolerance
	AC 50 Hz	AC 60 Hz	DC
R432030378	-	-	-10% / +10%
R432006327	-	-	-10% / +10%
R432030352	24 V	24 V	-
R432006322	110 V	120 V	-
R432006324	220 V	240 V	-
R432002465	-	-	-

Part No.	Operational voltage	Operational voltage	Voltage tolerance
	AC 50 Hz	AC 60 Hz	DC
R432002468	-	-	-

Part No.	Voltage tolerance	Voltage tolerance	Power consumption	Holding power
	AC 50 Hz	AC 60 Hz	DC	AC 50 Hz
R432030378	-	-	2.7 W	-
R432006327	-	-	2.7 W	-
R432030352	-10% / +10%	-10% / +10%	-	3.7 VA
R432006322	-10% / +10%	-10% / +10%	-	3.7 VA
R432006324	-10% / +10%	-10% / +10%	-	3.7 VA
R432002465	-	-	-	-
R432002468	-	-	-	-

Part No.	Holding power	Switch-on power	Switch-on power	Pilot
	AC 60 Hz	AC 50 Hz	AC 60 Hz	
R432030378	-	-	-	Internal
R432006327	-	-	-	Internal
R432030352	3.7 VA	6.4 VA	6.4 VA	Internal
R432006322	3.7 VA	6.4 VA	6.4 VA	Internal
R432006324	3.7 VA	6.4 VA	6.4 VA	Internal
R432002465	-	-	-	External
R432002468	-	-	-	Internal

Part No.	Valve plug connector	basic valve with electrical connector	Weight
R432030378	Without valve plug connector	-	2.45 kg
R432006327	Without valve plug connector	-	2.45 kg
R432030352	Without valve plug connector	-	2.45 kg
R432006322	Without valve plug connector	-	2.46 kg
R432006324	Without valve plug connector	-	2.46 kg
R432002465	Without valve plug connector	Basic valve without coil	2.09 kg
R432002468	Without valve plug connector	Basic valve without coil	2.09 kg

Nominal flow Q_n at 6 bar and $\Delta p = 1$ bar

MO = Manual override

Technical information

The min. control pressure must be adhered to, since otherwise faulty switching and valve failure may result!

The pressure dew point must be at least 15 °C under ambient and medium temperature and may not exceed 3 °C .

The oil content of compressed air must remain constant during the life cycle.

Use only the approved oils from AVENTICS. Further information can be found in the "Technical information" document (available in the MediaCentre).

Technical information

Material	
Housing	Die cast zinc, painted gray Die-cast aluminum, painted gray

Dimensions

Dimensions in inches

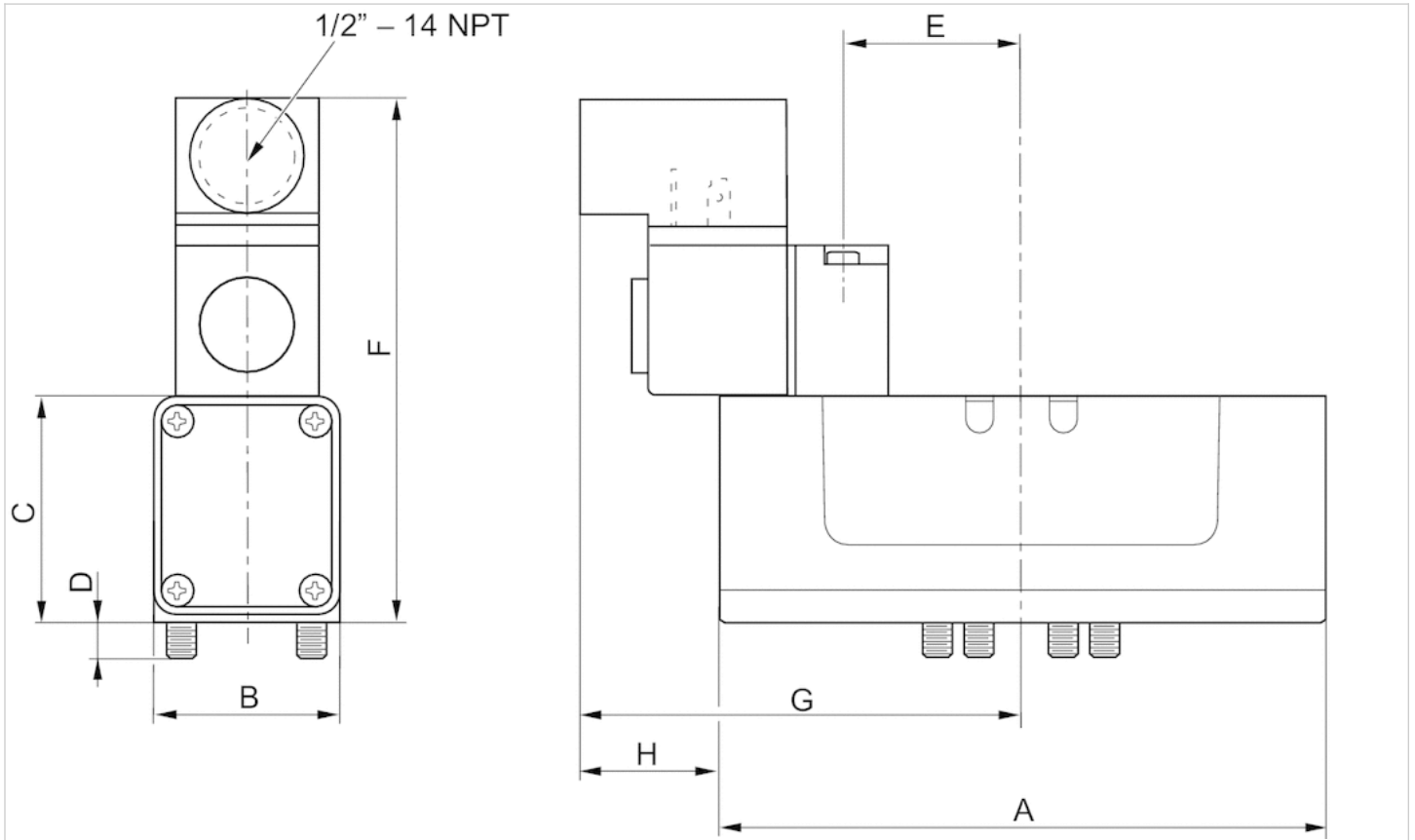

Dimensions in inches

Part No.	A	B	C	D	E	F	G	H
R432030378	8.62	3.09	2.89	0.41	1.62	5.23	6.65	0.68
R432006327	8.62	3.09	2.89	0.41	1.62	5.23	6.65	0.68
R432030352	8.62	3.09	2.89	0.41	1.62	5.23	6.65	0.68
R432006322	8.62	3.09	2.89	0.41	1.62	5.23	6.65	0.68
R432006324	8.62	3.09	2.89	0.41	1.62	5.23	6.65	0.68
-	-	-	-	-	-	-	-	-
R432002468	8.62	3.09	2.89	0.41	1.62	5.23	6.65	0.68





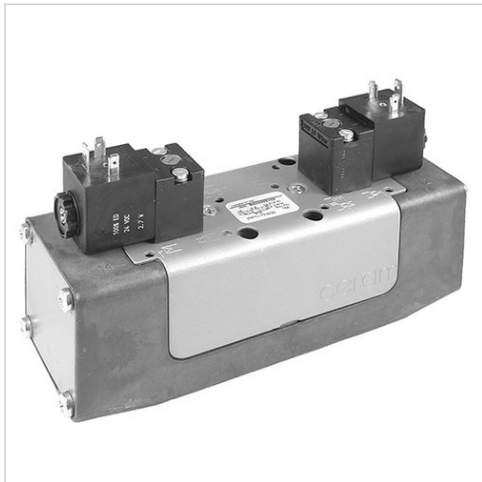

5/2-directional valve, Series CERAM™, size 4

- 5/2
- Qn = 7500 l/min
- Pilot valve width : 30 mm CNOMO
- Plate connection
- Electrical connection : Plug, EN 175301-803, form A
- Can be assembled into blocks
- Manual override : with detent, without detent
- double solenoid single solenoid
- Pilot : Internal External



Activation	Electrically
Sealing principle	Ceramic
Blocking principle	Single base plate principle
Standards	ISO 5599-1, ISO 4
Working pressure min./max.	0 ... 10.3 bar
Control pressure min./max.	See table below
Ambient temperature min./max.	-15 ... 66 °C
Medium temperature min./max.	-15 ... 66 °C
Medium	Compressed air
Nominal flow Qn	7500 l/min
Compressed air connection	according to ISO 5599-1
Protection class according to NEMA	NEMA 4
Weight	See table below

Technical data

Part No.		MO	Compressed air connection		Operational voltage
				Pilot Exhaust	DC
R432030353		TR-TR-TR-TR-TR-TR-TR-TR-TR-TR		Base plate ISO 5599-1	12 V
R432006341				Base plate ISO 5599-1	24 V
R432030178				Base plate ISO 5599-1	-
R432006339				Base plate ISO 5599-1	-
R432006340				Base plate ISO 5599-1	-
R432002466				Base plate ISO 5599-1	-
R432002469				Base plate ISO 5599-1	-

Part No.	Operational voltage		Operational voltage	Voltage tolerance
	AC 50 Hz	AC 60 Hz	AC 60 Hz	DC
R432030353	-	-	-	-10% / +10%
R432006341	-	-	-	-10% / +10%
R432030178	24 V	24 V	24 V	-
R432006339	110 V	120 V	120 V	-
R432006340	220 V	240 V	240 V	-
R432002466	-	-	-	-
R432002469	-	-	-	-

Part No.	Voltage tolerance	Voltage tolerance	Power consumption	Holding power
	AC 50 Hz	AC 60 Hz	DC	AC 50 Hz
R432030353	-	-	2.7 W	-
R432006341	-	-	2.7 W	-
R432030178	-10% / +10%	-10% / +10%	-	3.7 VA
R432006339	-10% / +10%	-10% / +10%	-	3.7 VA
R432006340	-10% / +10%	-10% / +10%	-	3.7 VA
R432002466	-	-	-	-
R432002469	-	-	-	-

Part No.	Holding power	Switch-on power	Switch-on power	Pilot	Control pressure min./max.
	AC 60 Hz	AC 50 Hz	AC 60 Hz		
R432030353	-	-	-	Internal	2 ... 10.3 bar
R432006341	-	-	-	Internal	2 ... 10.3 bar
R432030178	3.7 VA	6.4 VA	6.4 VA	Internal	2 ... 10.3 bar
R432006339	3.7 VA	6.4 VA	6.4 VA	Internal	2 ... 10.3 bar
R432006340	3.7 VA	6.4 VA	6.4 VA	Internal	2 ... 10.3 bar
R432002466	-	-	-	External	2.5 ... 10.3 bar
R432002469	-	-	-	Internal	2 ... 10.3 bar

Part No.	Valve plug connector	basic valve with electrical connector
R432030353	Without valve plug connector	-
R432006341	Without valve plug connector	-
R432030178	Without valve plug connector	-
R432006339	Without valve plug connector	-
R432006340	Without valve plug connector	-

Part No.	Valve plug connector	basic valve with electrical connector
R432002466	Without valve plug connector	Basic valve without coil
R432002469	Without valve plug connector	Basic valve without coil

Part No.	Mounting screw	Weight
R432030353	M8 with hexagon socket	2.46 kg
R432006341	M8 with hexagon socket	2.46 kg
R432030178	M8 with hexagon socket	2.46 kg
R432006339	M8 with hexagon socket	2.46 kg
R432006340	M8 with hexagon socket	2.46 kg
R432002466	M5 with hexagon socket	2.32 kg
R432002469	M8 with hexagon socket	2.32 kg

Nominal flow Q_n at 6 bar and $\Delta p = 1$ bar

MO = Manual override

Technical information

The min. control pressure must be adhered to, since otherwise faulty switching and valve failure may result!

The pressure dew point must be at least 15 °C under ambient and medium temperature and may not exceed 3 °C .

The oil content of compressed air must remain constant during the life cycle.

Use only the approved oils from AVENTICS. Further information can be found in the "Technical information" document (available in the MediaCentre).

Technical information

Material	
Housing	Die-cast aluminum, painted gray

Dimensions

Dimensions in inches

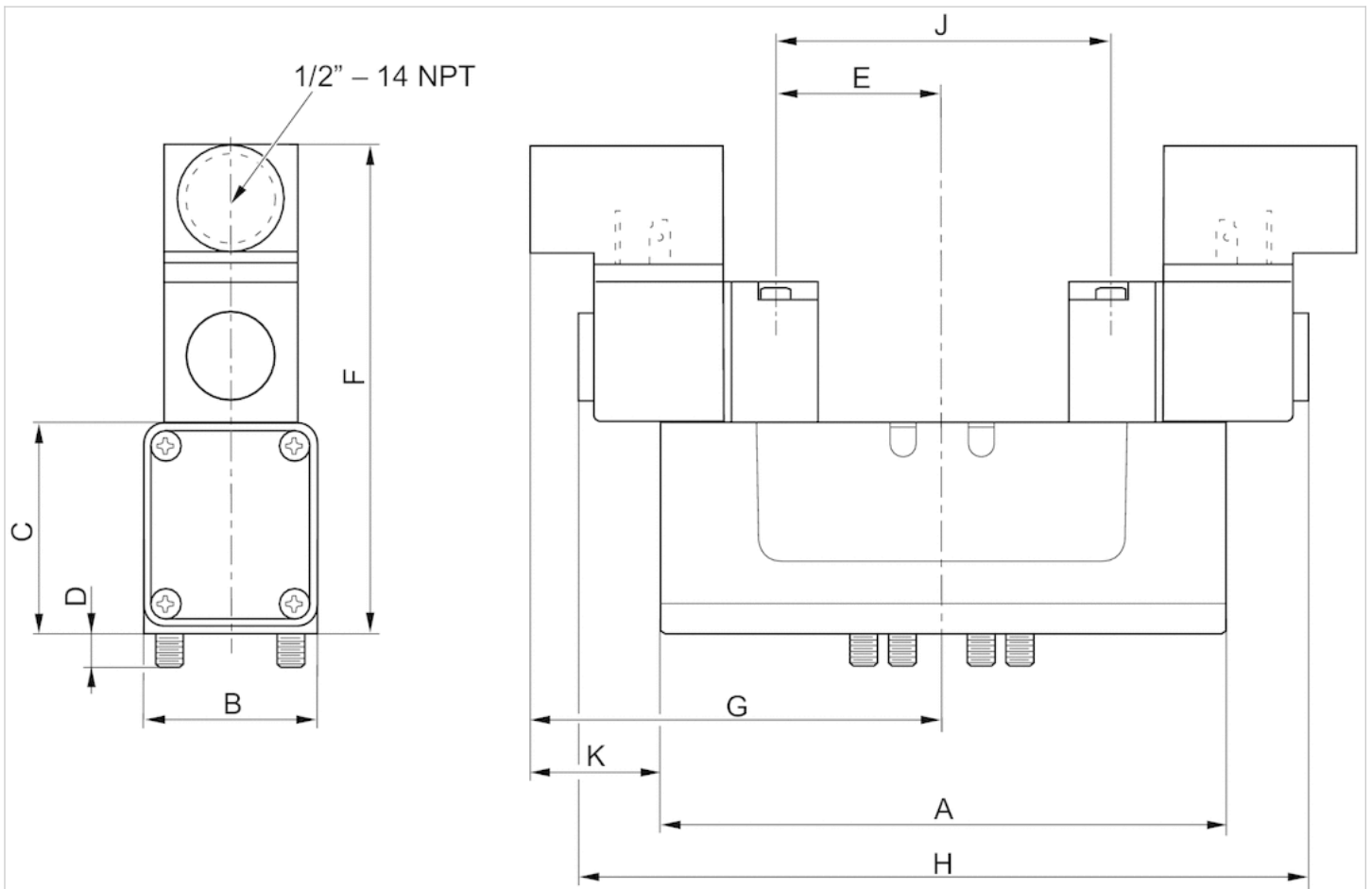

Dimensions in inches

Part No.	A	B	C	D	E	F	G	H	J	K
R432030353	8.62	3.09	2.89	0.41	1.62	5.32	6.65	13.31	3.25	0.68
R432006341	8.62	3.09	2.89	0.41	1.62	5.32	6.65	13.31	3.25	0.68
R432030178	8.62	3.09	2.89	0.41	1.62	5.32	6.65	13.31	3.25	0.68
R432006339	8.62	3.09	2.89	0.41	1.62	5.32	6.65	13.31	3.25	0.68
R432006340	8.62	3.09	2.89	0.41	1.62	5.32	6.65	13.31	3.25	0.68
-	-	-	-	-	-	-	-	-	-	-
R432002469	8.62	3.09	2.89	0.41	1.62	5.32	6.65	13.31	3.25	0.68



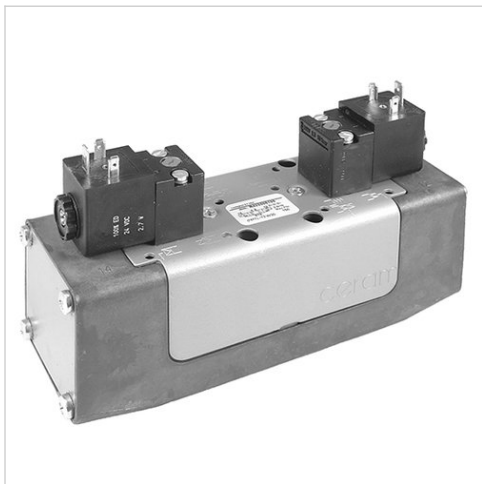

5/3-directional valve, Series CERAM™, size 4

- 5/3
- $Q_n = 7500$ l/min
- Pilot valve width : 30 mm CNOMO
- closed center
- Plate connection
- Electrical connection : Plug, EN 175301-803, form A
- Can be assembled into blocks
- Manual override : with detent, without detent
- double solenoid single solenoid
- Pilot : Internal External



Activation	Electrically
Blocking principle	Single base plate principle
Standards	ISO 5599-1, ISO 4
Working pressure min./max.	0 ... 10.3 bar
Control pressure min./max.	See table below
Ambient temperature min./max.	-15 ... 66 °C
Medium temperature min./max.	-15 ... 66 °C
Medium	Compressed air
Nominal flow Q_n	7500 l/min
Compressed air connection	according to ISO 5599-1
Protection class according to NEMA	NEMA 4
mounting screws	M8 with hexagon socket
Weight	See table below

Technical data

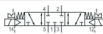
Part No.		MO	Compressed air connection		
			Pilot Exhaust		
R432006292		IT-R-R-IT-R-IT-R-IT-R-IT-R-	closed center	Base plate ISO 5599-1	
R432006293			closed center	Base plate ISO 5599-1	
R432030338			closed center	Base plate ISO 5599-1	
R432006290			closed center	Base plate ISO 5599-1	
R432006291			closed center	Base plate ISO 5599-1	
R432002461			IT-R-R	closed center	Base plate ISO 5599-1
R432002463	-			closed center	Base plate ISO 5599-1

Part No.	Operational voltage	Operational voltage	Operational voltage
	DC	AC 50 Hz	AC 60 Hz
R432006292	12 V	-	-
R432006293	24 V	-	-
R432030338	-	24 V	24 V
R432006290	-	110 V	120 V
R432006291	-	220 V	240 V
R432002461	-	-	-
R432002463	-	-	-

Part No.	Voltage tolerance	Voltage tolerance	Voltage tolerance	Power consumption
	DC	AC 50 Hz	AC 60 Hz	DC
R432006292	-10% / +10%	-	-	2.7 W
R432006293	-10% / +10%	-	-	2.7 W
R432030338	-	-10% / +10%	-10% / +10%	-
R432006290	-	-10% / +10%	-10% / +10%	-
R432006291	-	-10% / +10%	-10% / +10%	-
R432002461	-	-	-	-
R432002463	-	-	-	-

Part No.	Holding power	Holding power	Switch-on power	Switch-on power	Pilot
	AC 50 Hz	AC 60 Hz	AC 50 Hz	AC 60 Hz	
R432006292	-	-	-	-	Internal
R432006293	-	-	-	-	Internal
R432030338	3.7 VA	3.7 VA	6.4 VA	6.4 VA	Internal
R432006290	3.7 VA	3.7 VA	6.4 VA	6.4 VA	Internal
R432006291	3.7 VA	3.7 VA	6.4 VA	6.4 VA	Internal
R432002461	-	-	-	-	External
R432002463	-	-	-	-	Internal

Part No.	Control pressure min./max.	Valve plug connector
R432006292	2.5 ... 10.3 bar	Without valve plug connector
R432006293	2.5 ... 10.3 bar	Without valve plug connector
R432030338	2.5 ... 10.3 bar	Without valve plug connector
R432006290	2.5 ... 10.3 bar	Without valve plug connector
R432006291	2.5 ... 10.3 bar	Without valve plug connector
R432002461	-0.8 ... 10.3 bar	Without valve plug connector

Part No.	Control pressure min./max.	Valve plug connector
R432002463	2.5 ... 10.3 bar	Without valve plug connector

Part No.	basic valve with electrical connector	Weight
R432006292	-	2.54 kg
R432006293	-	2.45 kg
R432030338	-	-
R432006290	-	2.59 kg
R432006291	-	2.59 kg
R432002461	Basic valve without coil	2.41 kg
R432002463	Basic valve without coil	2.41 kg

Nominal flow Q_n at 6 bar and $\Delta p = 1$ bar

MO = Manual override

Technical information

The min. control pressure must be adhered to, since otherwise faulty switching and valve failure may result!

The pressure dew point must be at least 15 °C under ambient and medium temperature and may not exceed 3 °C .

The oil content of compressed air must remain constant during the life cycle.

Use only the approved oils from AVENTICS. Further information can be found in the "Technical information" document (available in the MediaCentre).

Technical information

Material	
Housing	Die cast zinc, painted gray Die-cast aluminum, painted gray

Dimensions

Dimensions in inches

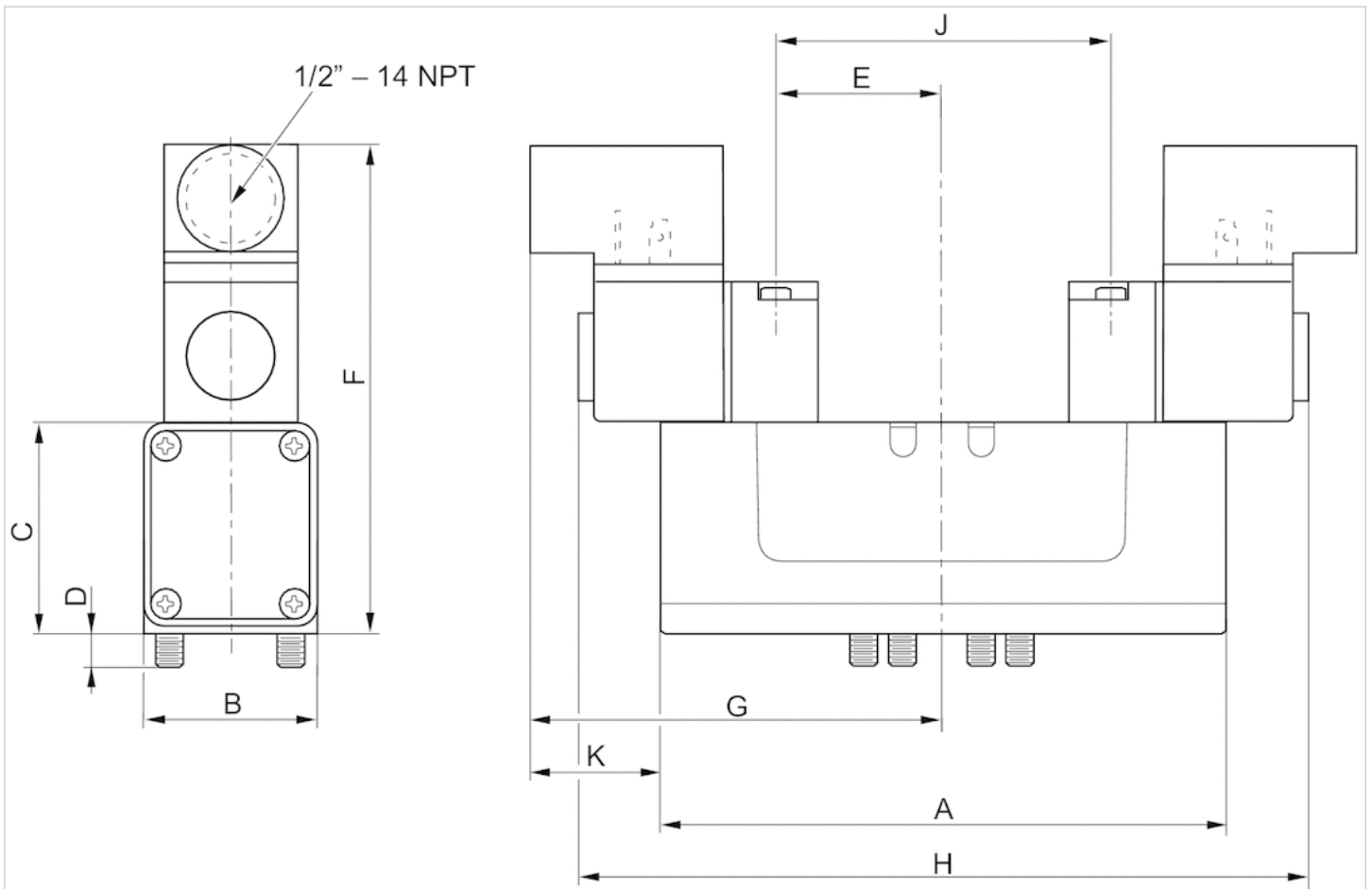

Dimensions in inches

Part No.	A	B	C	D	E	F	G	H	J	K
R432006292	8.62	3.09	2.89	0.41	1.62	5.32	6.65	13.31	3.25	0.68
R432006293	8.62	3.09	2.89	0.41	1.62	5.32	6.65	13.31	3.25	0.68
R432030338	8.62	3.09	2.89	0.41	1.62	5.32	6.65	13.31	3.25	0.68
R432006290	8.62	3.09	2.89	0.41	1.62	5.32	6.65	13.31	3.25	0.68
R432006291	8.62	3.09	2.89	0.41	1.62	5.32	6.65	13.31	3.25	0.68
-	-	-	-	-	-	-	-	-	-	-
R432002463	8.62	3.09	2.89	0.41	1.62	5.32	6.65	13.31	3.25	0.68

5/3-directional valve, Series CERAM™, size 4

R432029042

Series CERAM™, size 4

■ Qn max. [[7500] l/min]

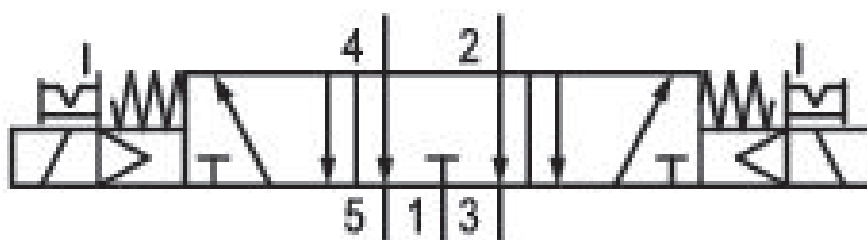
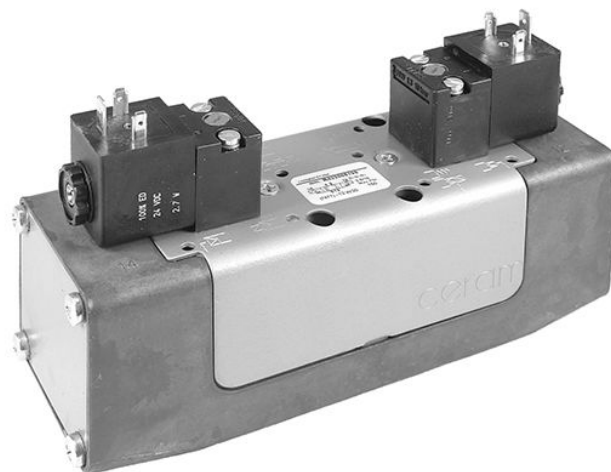

Technical data

Industry
Industrial

Activation
Electrically

Nominal flow Qn
7500 l/min

Switching principle
5/3

Version
Exhausted Center

Working pressure min.
0 bar

Working pressure max
10.3 bar

DC operating voltage
12 V

Voltage tolerance DC
-10% / +10%

Manual override
with detent
without detent

Electrical connection type
Plug

Electrical connection size
EN 175301-803, form A

Actuating control
Double Solenoid
Sealing principle
Ceramic

Pilot
Internal
Standards
ISO 5599-1

Pilot valve width
30 mm CNOMO
Frame size
ISO 4
Valve plug connector
Without valve plug connector

Connection type
Plate connection
Blocking principle
Single base plate principle
Can be assembled into blocks
Can be assembled into blocks

Control pressure min.
2.5 bar
Control pressure max.
10.3 bar
Min. ambient temperature
-15 °C
Max. ambient temperature
66 °C

Min. medium temperature
-15 °C
Max. medium temperature
66 °C
Medium
Compressed air

Standard compressed air connection
according to ISO 5599-1

Compressed air connection pilot exhaust
Base plate ISO 5599-1

Power consumption DC
2.7 W

Pilot valve width
30 mm CNOMO
Protection class according to NEMA
NEMA 4
mounting screws
M8 with hexagon socket

Mounting screw tightening torque
9.2 Nm
Weight
2.46 kg

Material

Housing material
Die-cast aluminum
Surface housing
painted gray

Part No.
R432029042

Technical information

The min. control pressure must be adhered to, since otherwise faulty switching and valve failure may result!

The pressure dew point must be at least 15 °C under ambient and medium temperature and may not exceed 3 °C .

The oil content of compressed air must remain constant during the life cycle.

Use only the approved oils from AVENTICS. Further information can be found in the “Technical information” document (available in <https://www.emerson.com/en-us/support>).

Dimensions in inches

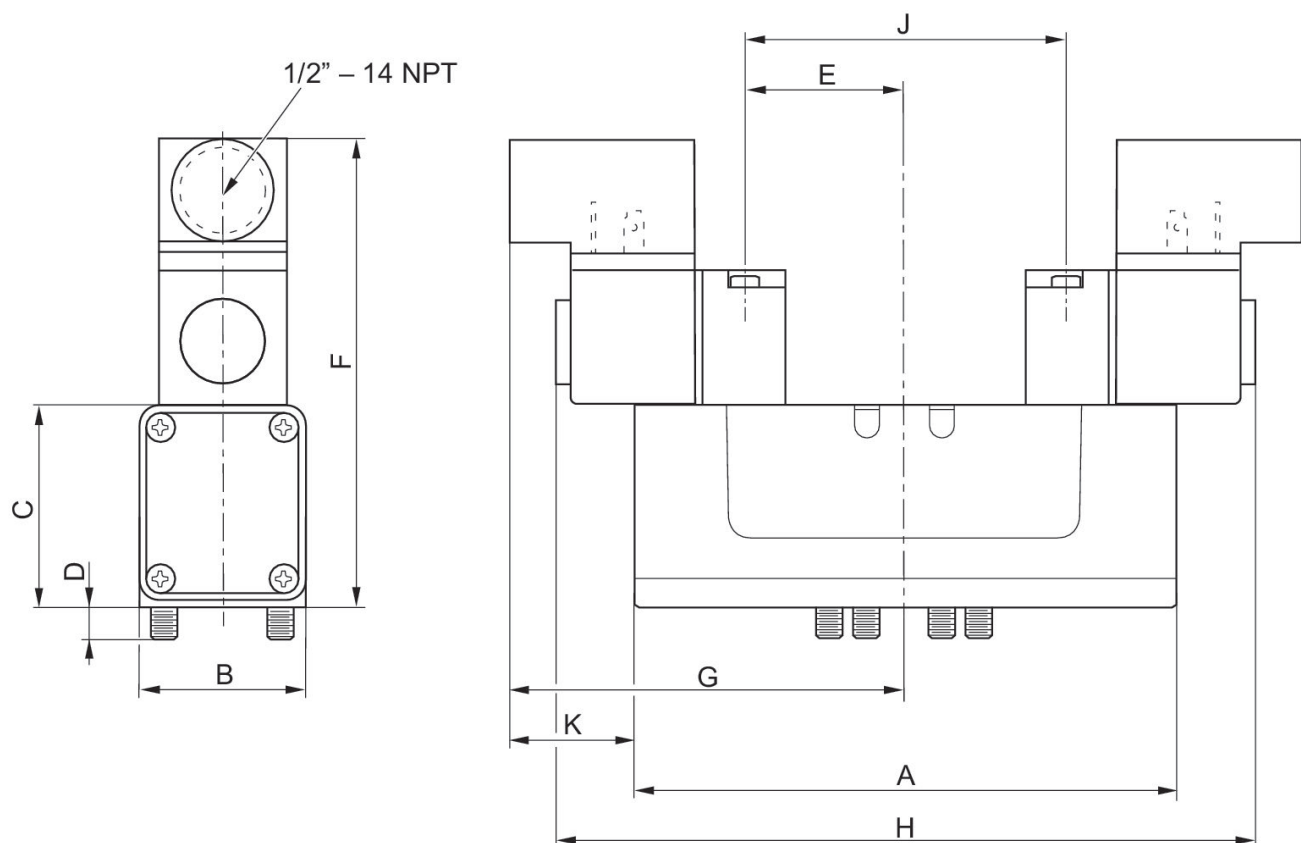

Dimensions in inches

Part No.	A	B	C	D	E	F	G	H	J
R432002460	8.62	3.09	2.89	0.41	1.62	5.32	6.65	13.31	3.25
R432029042	8.62	3.09	2.89	0.41	1.62	5.32	6.65	13.31	3.25
R432006284	8.62	3.09	2.89	0.41	1.62	5.32	6.65	13.31	3.25
R432030339	8.62	3.09	2.89	0.41	1.62	5.32	6.65	13.31	3.25

Part No.	A	B	C	D	E	F	G	H	J
R432006283	8.62	3.09	2.89	0.41	1.62	5.32	6.65	13.31	3.25
R432030340	8.62	3.09	2.89	0.41	1.62	5.32	6.65	13.31	3.25
R432002462	8.62	3.09	2.89	0.41	1.62	5.32	6.65	13.31	3.25

K
0.68
0.68
0.68
0.68
0.68
0.68
0.68

5/3-directional valve, Series CERAM™, size 4

R432006284

Series CERAM™, size 4

■ Qn max. [[7500] l/min]

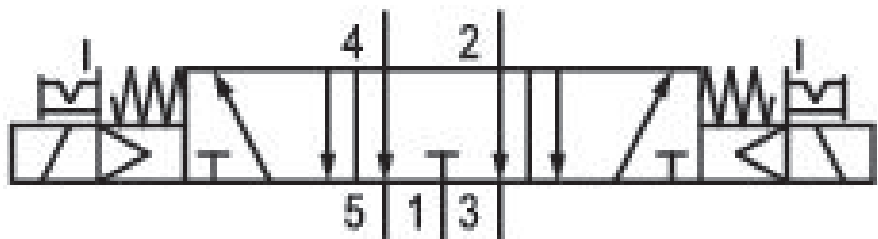
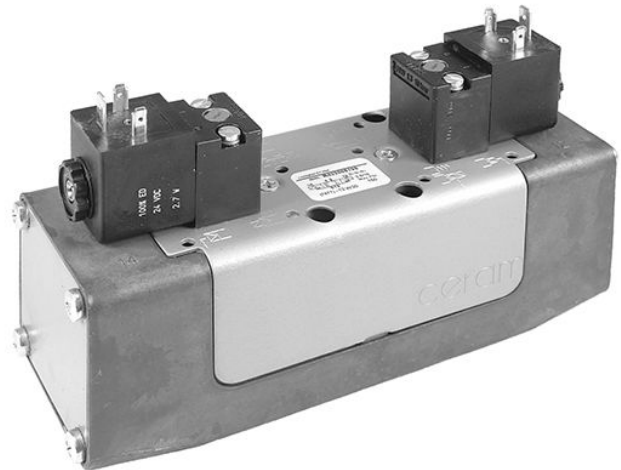

Technical data

Industry
Industrial

Activation
Electrically

Nominal flow Qn
7500 l/min

Switching principle
5/3

Version
Exhausted Center

Working pressure min.
0 bar

Working pressure max
10.3 bar

DC operating voltage
24 V

Voltage tolerance DC
-10% / +10%

Manual override
with detent
without detent

Electrical connection type
Plug

Electrical connection size
EN 175301-803, form A

Actuating control
Double Solenoid
Sealing principle
Ceramic

Pilot
Internal
Standards
ISO 5599-1

Pilot valve width
30 mm CNOMO
Frame size
ISO 4
Valve plug connector
Without valve plug connector

Connection type
Plate connection
Blocking principle
Single base plate principle
Can be assembled into blocks
Can be assembled into blocks

Control pressure min.
2.5 bar
Control pressure max.
10.3 bar
Min. ambient temperature
-15 °C
Max. ambient temperature
66 °C

Min. medium temperature
-15 °C
Max. medium temperature
66 °C
Medium
Compressed air

Standard compressed air connection
according to ISO 5599-1

Compressed air connection pilot exhaust
Base plate ISO 5599-1

Power consumption DC
2.7 W

Pilot valve width
30 mm CNOMO
Protection class according to NEMA
NEMA 4
mounting screws
M8 with hexagon socket

Mounting screw tightening torque
9.2 Nm
Weight
2.46 kg

Material

Housing material
Die-cast aluminum
Surface housing
painted gray

Part No.
R432006284

Technical information

The min. control pressure must be adhered to, since otherwise faulty switching and valve failure may result!

The pressure dew point must be at least 15 °C under ambient and medium temperature and may not exceed 3 °C .

The oil content of compressed air must remain constant during the life cycle.

Use only the approved oils from AVENTICS. Further information can be found in the “Technical information” document (available in <https://www.emerson.com/en-us/support>).

Dimensions in inches

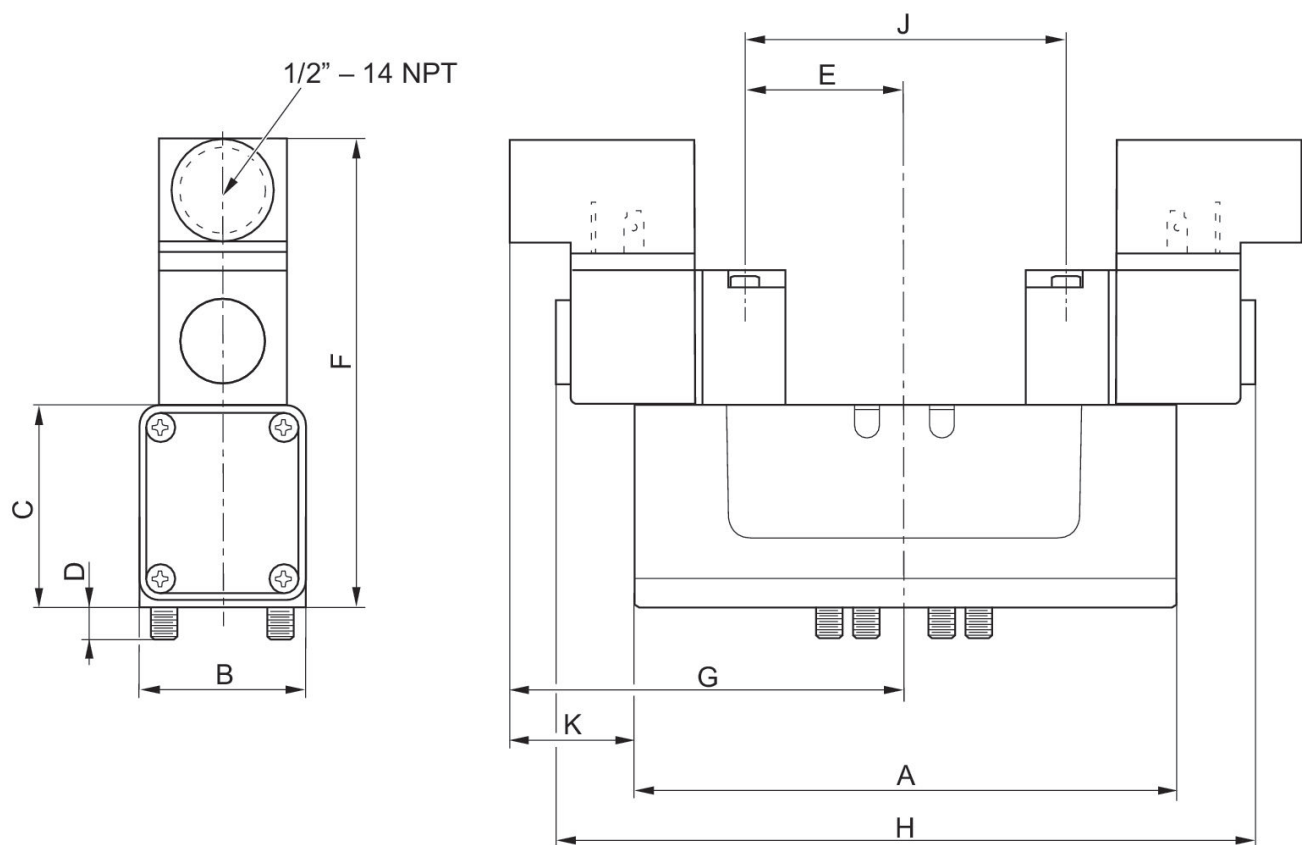

Dimensions in inches

Part No.	A	B	C	D	E	F	G	H	J
R432002460	8.62	3.09	2.89	0.41	1.62	5.32	6.65	13.31	3.25
R432029042	8.62	3.09	2.89	0.41	1.62	5.32	6.65	13.31	3.25
R432006284	8.62	3.09	2.89	0.41	1.62	5.32	6.65	13.31	3.25
R432030339	8.62	3.09	2.89	0.41	1.62	5.32	6.65	13.31	3.25

Part No.	A	B	C	D	E	F	G	H	J
R432006283	8.62	3.09	2.89	0.41	1.62	5.32	6.65	13.31	3.25
R432030340	8.62	3.09	2.89	0.41	1.62	5.32	6.65	13.31	3.25
R432002462	8.62	3.09	2.89	0.41	1.62	5.32	6.65	13.31	3.25

K
0.68
0.68
0.68
0.68
0.68
0.68
0.68

5/3-directional valve, Series CERAM™, size 4

R432030339

Series CERAM™, size 4

■ Qn max. [[7500] l/min]

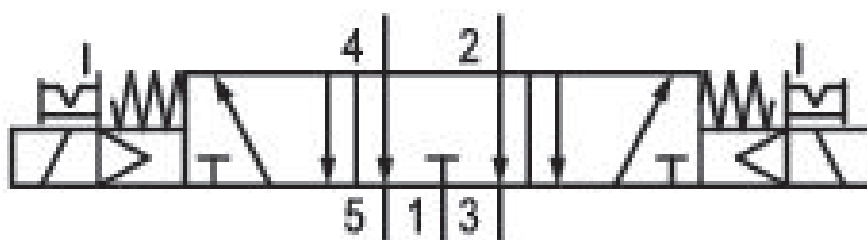
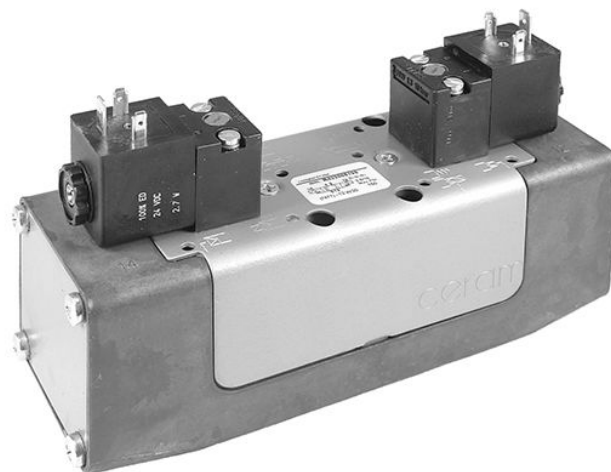

Technical data

Industry
Industrial

Activation
Electrically

Nominal flow Qn
7500 l/min

Switching principle
5/3

Version
Exhausted Center

Working pressure min.
0 bar

Working pressure max
10.3 bar

Operational voltage AC at 50 Hz
24 V

Operational voltage AC at 60 Hz
24 V

Voltage tolerance AC 50 Hz
-10% / +10%

Voltage tolerance AC 60 Hz
-10% / +10%

Manual override
with detent
without detent

Electrical connection type
Plug

Electrical connection size
EN 175301-803, form A

Actuating control
Double Solenoid

Pilot valve width
30 mm CNOMO

Frame size
ISO 4

Valve plug connector
Without valve plug connector

Control pressure min.
2.5 bar

Control pressure max.
10.3 bar

Min. ambient temperature
-15 °C

Max. ambient temperature
66 °C

Standard compressed air connection
according to ISO 5599-1

Holding power AC 50 Hz
3.7 VA

Holding power AC 60 Hz
3.7 VA

Pilot valve width
30 mm CNOMO

Protection class according to NEMA
NEMA 4

mounting screws
M8 with hexagon socket

Material

Housing material
Die-cast aluminum

Surface housing
painted gray

Sealing principle
Ceramic

Pilot
Internal

Standards
ISO 5599-1

Connection type
Plate connection

Blocking principle
Single base plate principle

Can be assembled into blocks
Can be assembled into blocks

Min. medium temperature
-15 °C

Max. medium temperature
66 °C

Medium
Compressed air

Compressed air connection pilot exhaust
Base plate ISO 5599-1

Switch-on power AC 50 Hz
6.4 VA

Switch-on power AC 60 Hz
6.4 VA

Mounting screw tightening torque
9.2 Nm

Weight
2.46 kg

Part No.
R432030339

Technical information

The min. control pressure must be adhered to, since otherwise faulty switching and valve failure may result!

The pressure dew point must be at least 15 °C under ambient and medium temperature and may not exceed 3 °C .

The oil content of compressed air must remain constant during the life cycle.

Use only the approved oils from AVENTICS. Further information can be found in the “Technical information” document (available in <https://www.emerson.com/en-us/support>).

Dimensions in inches

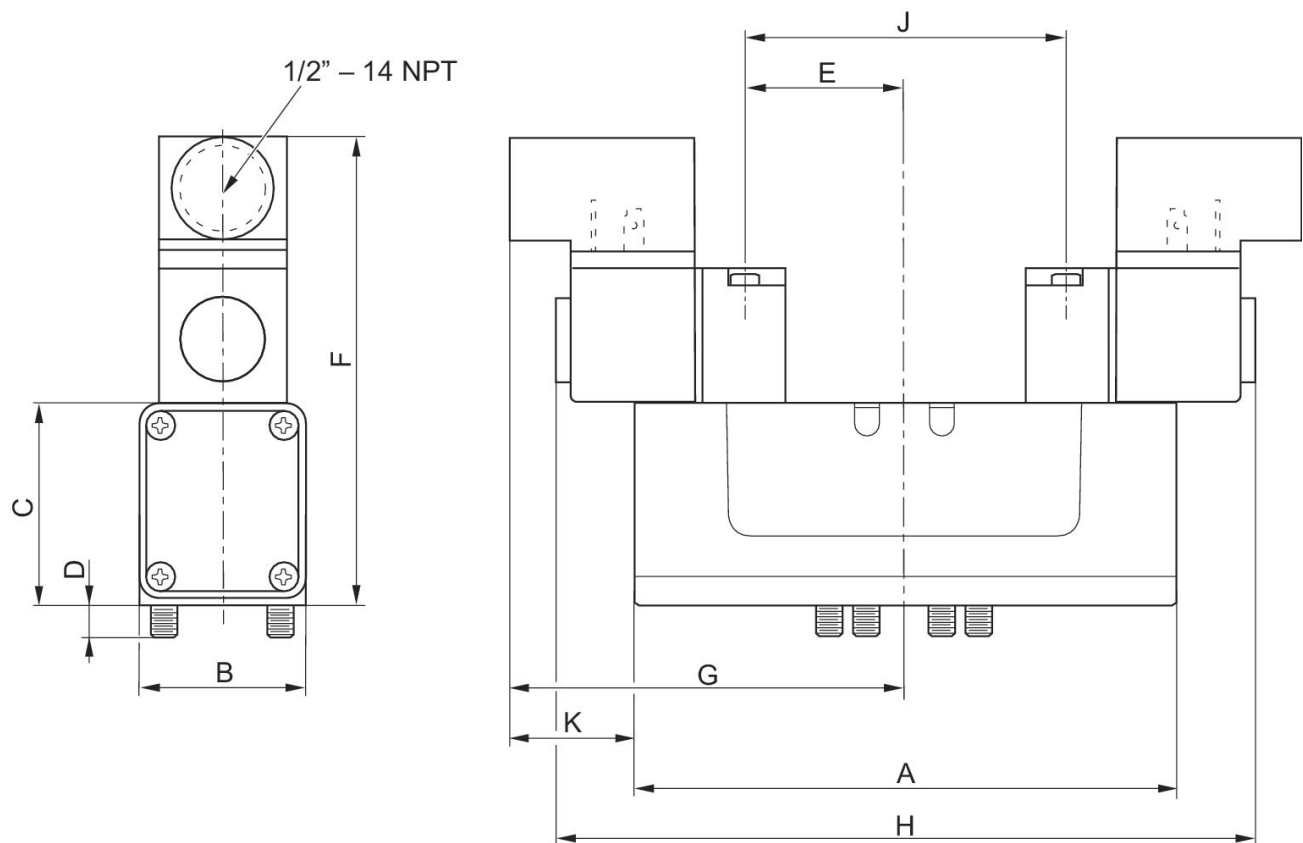

Dimensions in inches

Part No.	A	B	C	D	E	F	G	H	J
R432002460	8.62	3.09	2.89	0.41	1.62	5.32	6.65	13.31	3.25
R432029042	8.62	3.09	2.89	0.41	1.62	5.32	6.65	13.31	3.25
R432006284	8.62	3.09	2.89	0.41	1.62	5.32	6.65	13.31	3.25
R432030339	8.62	3.09	2.89	0.41	1.62	5.32	6.65	13.31	3.25

Part No.	A	B	C	D	E	F	G	H	J
R432006283	8.62	3.09	2.89	0.41	1.62	5.32	6.65	13.31	3.25
R432030340	8.62	3.09	2.89	0.41	1.62	5.32	6.65	13.31	3.25
R432002462	8.62	3.09	2.89	0.41	1.62	5.32	6.65	13.31	3.25

K
0.68
0.68
0.68
0.68
0.68
0.68
0.68

5/3-directional valve, Series CERAM™, size 4

R432006283

Series CERAM™, size 4

■ Qn max. [[7500] l/min]

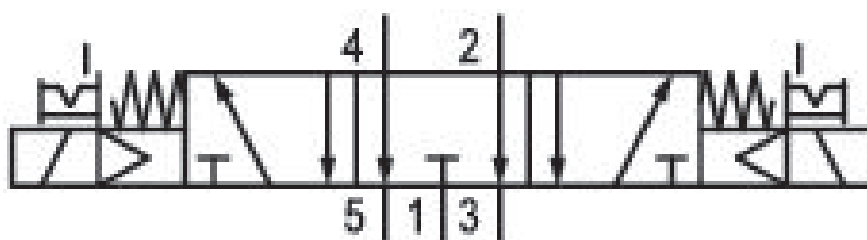
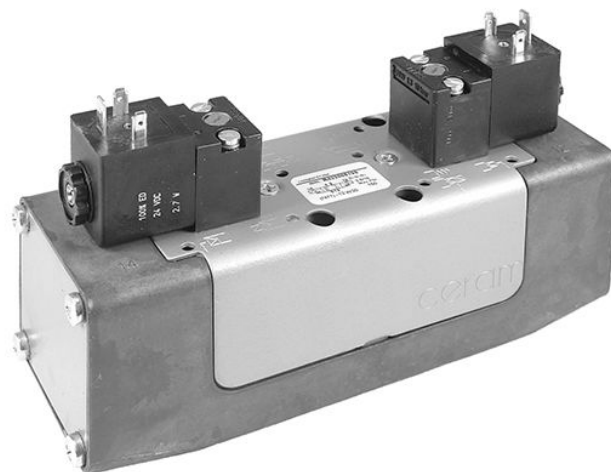

Technical data

Industry
Industrial

Activation
Electrically

Nominal flow Qn
7500 l/min

Switching principle
5/3

Version
Exhausted Center

Working pressure min.
0 bar

Working pressure max
10.3 bar

Operational voltage AC at 50 Hz
110 V

Operational voltage AC at 60 Hz
120 V

Voltage tolerance AC 50 Hz
-10% / +10%

Voltage tolerance AC 60 Hz
-10% / +10%

Manual override
with detent
without detent

Electrical connection type
Plug

Electrical connection size
EN 175301-803, form A

Actuating control
Double Solenoid

Pilot valve width
30 mm CNOMO

Frame size
ISO 4

Valve plug connector
Without valve plug connector

Control pressure min.
2.5 bar

Control pressure max.
10.3 bar

Min. ambient temperature
-15 °C

Max. ambient temperature
66 °C

Standard compressed air connection
according to ISO 5599-1

Holding power AC 50 Hz
3.7 VA

Holding power AC 60 Hz
3.7 VA

Pilot valve width
30 mm CNOMO

Protection class according to NEMA
NEMA 4

mounting screws
M8 with hexagon socket

Material

Housing material
Die-cast aluminum

Surface housing
painted gray

Sealing principle
Ceramic

Pilot
Internal

Standards
ISO 5599-1

Connection type
Plate connection

Blocking principle
Single base plate principle

Can be assembled into blocks
Can be assembled into blocks

Min. medium temperature
-15 °C

Max. medium temperature
66 °C

Medium
Compressed air

Compressed air connection pilot exhaust
Base plate ISO 5599-1

Switch-on power AC 50 Hz
6.4 VA

Switch-on power AC 60 Hz
6.4 VA

Mounting screw tightening torque
9.2 Nm

Weight
2.46 kg

Part No.
R432006283

Technical information

The min. control pressure must be adhered to, since otherwise faulty switching and valve failure may result!

The pressure dew point must be at least 15 °C under ambient and medium temperature and may not exceed 3 °C .

The oil content of compressed air must remain constant during the life cycle.

Use only the approved oils from AVENTICS. Further information can be found in the “Technical information” document (available in <https://www.emerson.com/en-us/support>).

Dimensions in inches

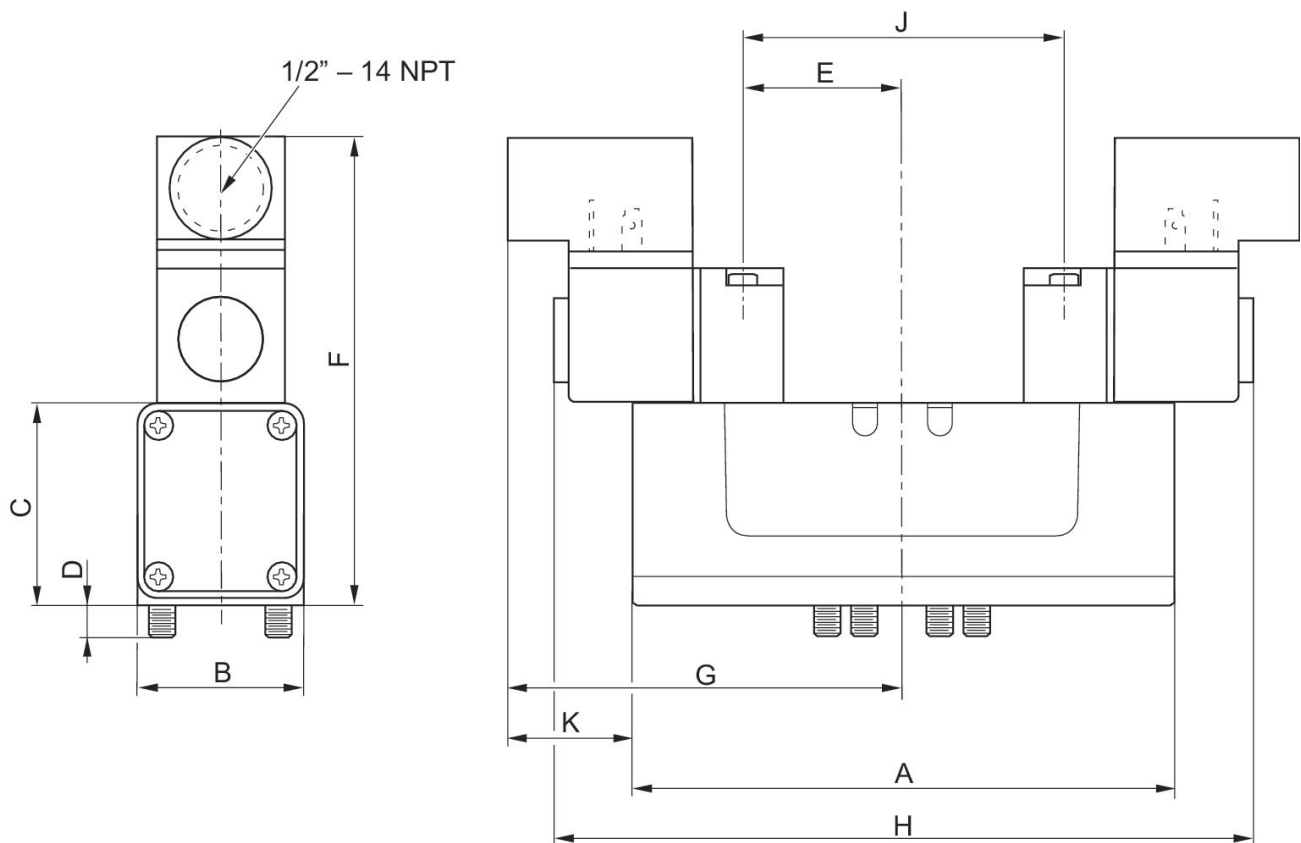

Dimensions in inches

Part No.	A	B	C	D	E	F	G	H	J
R432002460	8.62	3.09	2.89	0.41	1.62	5.32	6.65	13.31	3.25
R432029042	8.62	3.09	2.89	0.41	1.62	5.32	6.65	13.31	3.25
R432006284	8.62	3.09	2.89	0.41	1.62	5.32	6.65	13.31	3.25
R432030339	8.62	3.09	2.89	0.41	1.62	5.32	6.65	13.31	3.25

Part No.	A	B	C	D	E	F	G	H	J
R432006283	8.62	3.09	2.89	0.41	1.62	5.32	6.65	13.31	3.25
R432030340	8.62	3.09	2.89	0.41	1.62	5.32	6.65	13.31	3.25
R432002462	8.62	3.09	2.89	0.41	1.62	5.32	6.65	13.31	3.25

K
0.68
0.68
0.68
0.68
0.68
0.68
0.68

5/3-directional valve, Series CERAM™, size 4

R432030340

Series CERAM™, size 4

■ Qn max. [[7500] l/min]

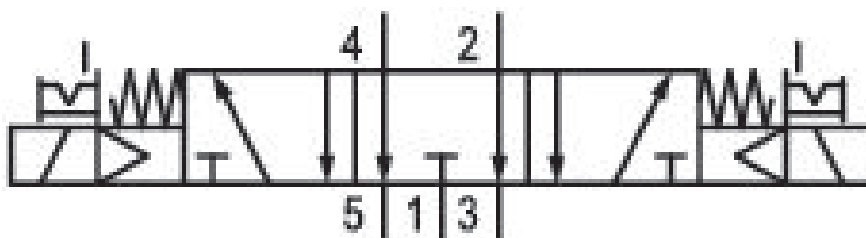
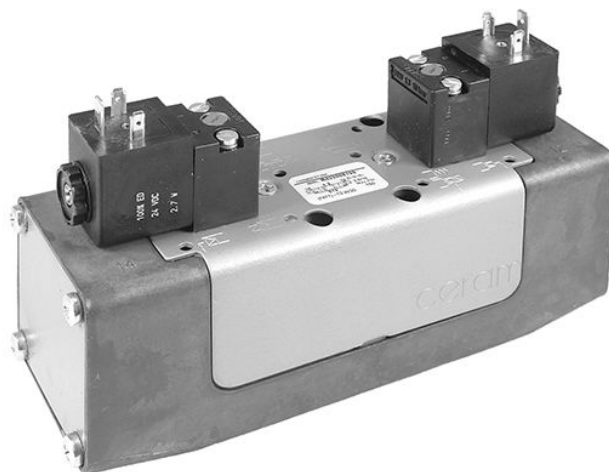

Technical data

Industry
Industrial

Activation
Electrically

Nominal flow Qn
7500 l/min

Switching principle
5/3

Version
Exhausted Center

Working pressure min.
0 bar

Working pressure max
10.3 bar

Operational voltage AC at 50 Hz
220 V

Operational voltage AC at 60 Hz
240 V

Voltage tolerance AC 50 Hz
-10% / +10%

Voltage tolerance AC 60 Hz
-10% / +10%

Manual override
with detent
without detent

Electrical connection type
Plug

Electrical connection size
EN 175301-803, form A

Actuating control
Double Solenoid

Pilot valve width
30 mm CNOMO

Frame size
ISO 4

Valve plug connector
Without valve plug connector

Control pressure min.
2.5 bar

Control pressure max.
10.3 bar

Min. ambient temperature
-15 °C

Max. ambient temperature
66 °C

Standard compressed air connection
according to ISO 5599-1

Holding power AC 50 Hz
3.7 VA

Holding power AC 60 Hz
3.7 VA

Pilot valve width
30 mm CNOMO

Protection class according to NEMA
NEMA 4

mounting screws
M8 with hexagon socket

Material

Housing material
Die-cast aluminum

Surface housing
painted gray

Sealing principle
Ceramic

Pilot
Internal

Standards
ISO 5599-1

Connection type
Plate connection

Blocking principle
Single base plate principle

Can be assembled into blocks
Can be assembled into blocks

Min. medium temperature
-15 °C

Max. medium temperature
66 °C

Medium
Compressed air

Compressed air connection pilot exhaust
Base plate ISO 5599-1

Switch-on power AC 50 Hz
6.4 VA

Switch-on power AC 60 Hz
6.4 VA

Mounting screw tightening torque
9.2 Nm

Weight
2.46 kg

Part No.
R432030340

Technical information

The min. control pressure must be adhered to, since otherwise faulty switching and valve failure may result!

The pressure dew point must be at least 15 °C under ambient and medium temperature and may not exceed 3 °C .

The oil content of compressed air must remain constant during the life cycle.

Use only the approved oils from AVENTICS. Further information can be found in the “Technical information” document (available in <https://www.emerson.com/en-us/support>).

Dimensions in inches

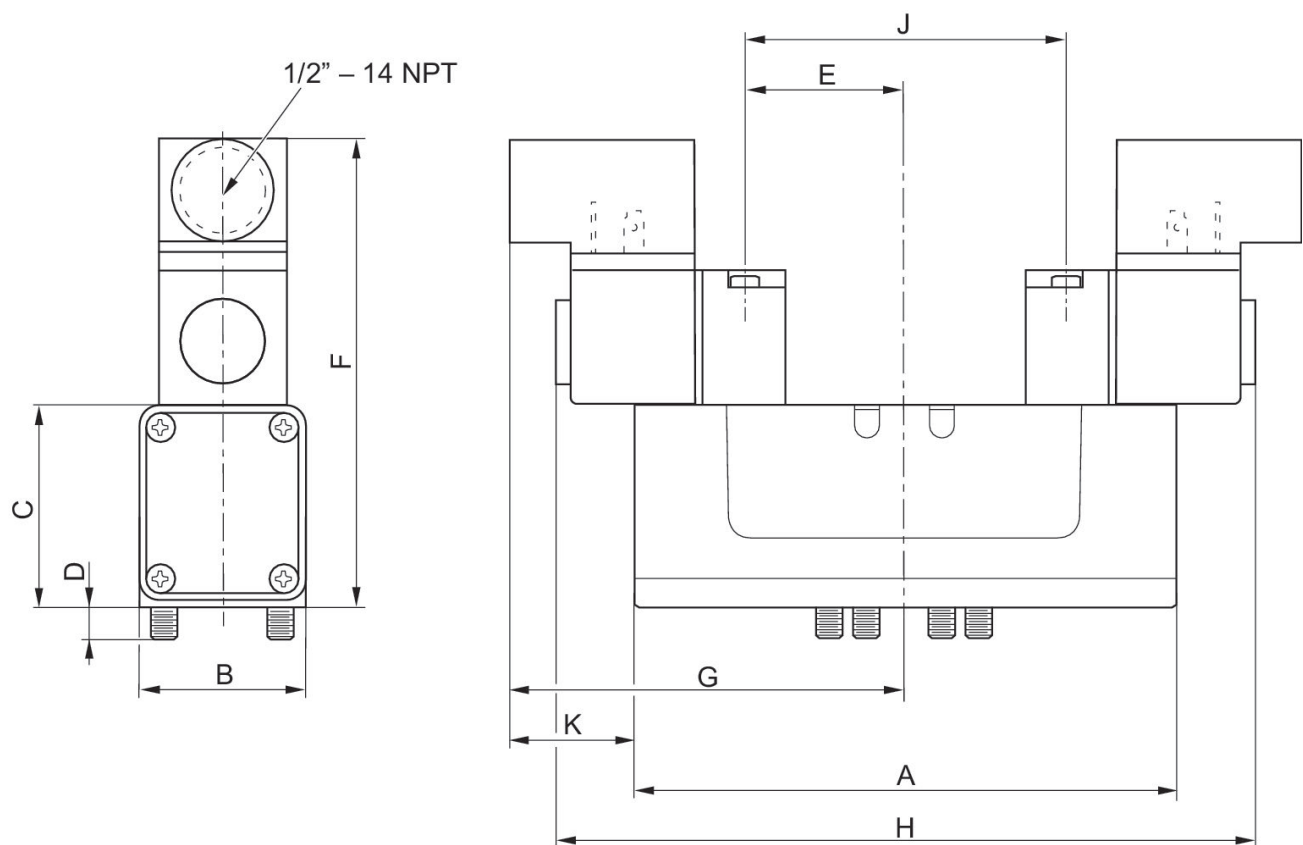

Dimensions in inches

Part No.	A	B	C	D	E	F	G	H	J
R432002460	8.62	3.09	2.89	0.41	1.62	5.32	6.65	13.31	3.25
R432029042	8.62	3.09	2.89	0.41	1.62	5.32	6.65	13.31	3.25
R432006284	8.62	3.09	2.89	0.41	1.62	5.32	6.65	13.31	3.25
R432030339	8.62	3.09	2.89	0.41	1.62	5.32	6.65	13.31	3.25

Part No.	A	B	C	D	E	F	G	H	J
R432006283	8.62	3.09	2.89	0.41	1.62	5.32	6.65	13.31	3.25
R432030340	8.62	3.09	2.89	0.41	1.62	5.32	6.65	13.31	3.25
R432002462	8.62	3.09	2.89	0.41	1.62	5.32	6.65	13.31	3.25

K
0.68
0.68
0.68
0.68
0.68
0.68
0.68

5/3-directional valve, Series CERAM™, size 4

R432002462

Series CERAM™, size 4

■ Qn max. [[7500] l/min]

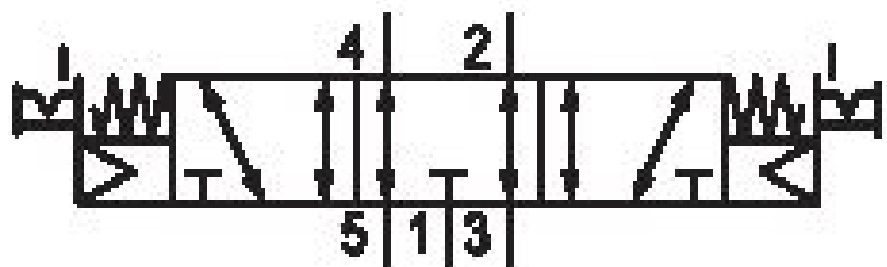
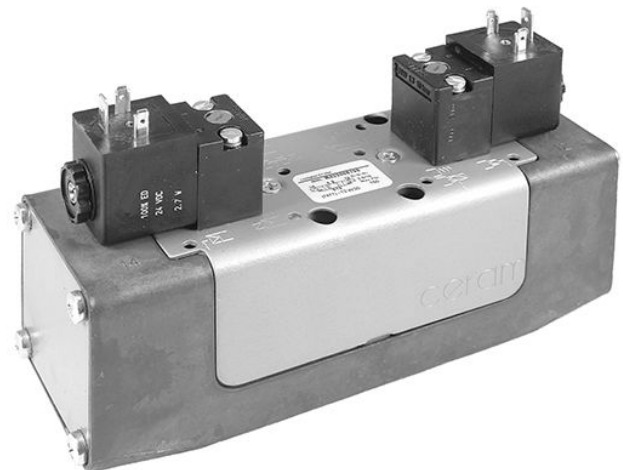

Technical data

Industry
Industrial

Activation
Electrically

Nominal flow Qn
7500 l/min

Switching principle
5/3

Version
Exhausted Center

Working pressure min.
0 bar

Working pressure max
10.3 bar

Electrical connection type
Plug

Electrical connection size
EN 175301-803, form A

Actuating control
Double Solenoid

Sealing principle
Ceramic

Pilot
Internal

Standards
ISO 5599-1

Pilot valve width
30 mm CNOMO

Frame size
ISO 4

basic valve with electrical connector
Basic valve without coil

Valve plug connector
Without valve plug connector

Control pressure min.
2.5 bar

Control pressure max.
10.3 bar

Min. ambient temperature
-15 °C

Max. ambient temperature
66 °C

Standard compressed air connection
according to ISO 5599-1

Pilot valve width
30 mm CNOMO

Protection class according to NEMA
NEMA 4

mounting screws
M8 with hexagon socket

Material

Housing material
Die-cast aluminum

Surface housing
painted gray

Connection type
Plate connection

Blocking principle
Single base plate principle

Can be assembled into blocks
Can be assembled into blocks

Min. medium temperature
-15 °C

Max. medium temperature
66 °C

Medium
Compressed air

Compressed air connection pilot exhaust
Base plate ISO 5599-1

Mounting screw tightening torque
9.2 Nm

Weight
2.46 kg

Part No.
R432002462

Technical information

The min. control pressure must be adhered to, since otherwise faulty switching and valve failure may result!

The pressure dew point must be at least 15 °C under ambient and medium temperature and may not exceed 3 °C .

The oil content of compressed air must remain constant during the life cycle.

Use only the approved oils from AVENTICS. Further information can be found in the “Technical information” document (available in <https://www.emerson.com/en-us/support>).

Dimensions in inches

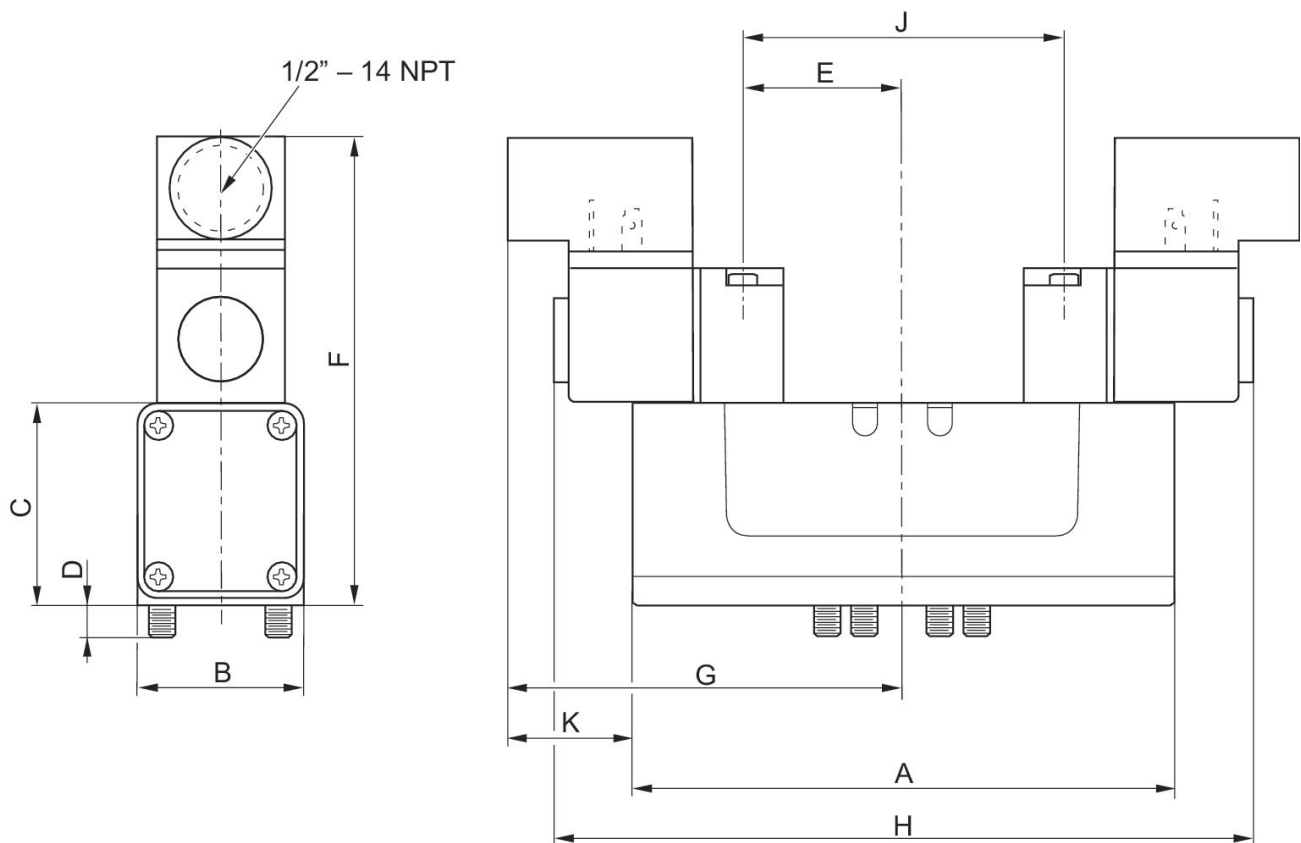

Dimensions in inches

Part No.	A	B	C	D	E	F	G	H	J
R432002460	8.62	3.09	2.89	0.41	1.62	5.32	6.65	13.31	3.25
R432029042	8.62	3.09	2.89	0.41	1.62	5.32	6.65	13.31	3.25
R432006284	8.62	3.09	2.89	0.41	1.62	5.32	6.65	13.31	3.25
R432030339	8.62	3.09	2.89	0.41	1.62	5.32	6.65	13.31	3.25

Part No.	A	B	C	D	E	F	G	H	J
R432006283	8.62	3.09	2.89	0.41	1.62	5.32	6.65	13.31	3.25
R432030340	8.62	3.09	2.89	0.41	1.62	5.32	6.65	13.31	3.25
R432002462	8.62	3.09	2.89	0.41	1.62	5.32	6.65	13.31	3.25

K
0.68
0.68
0.68
0.68
0.68
0.68
0.68

5/3-directional valve, Series CERAM™, size 4

R432002460

Series CERAM™, size 4

■ Qn max. [[7500] l/min]

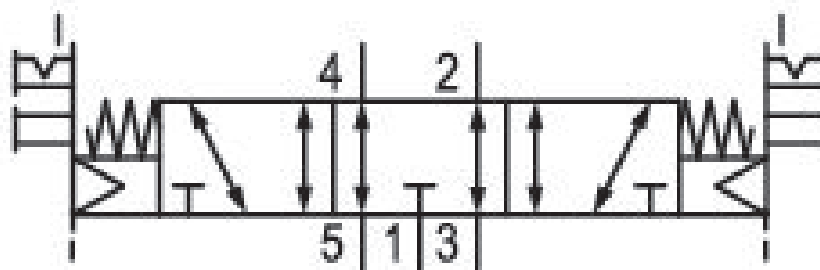
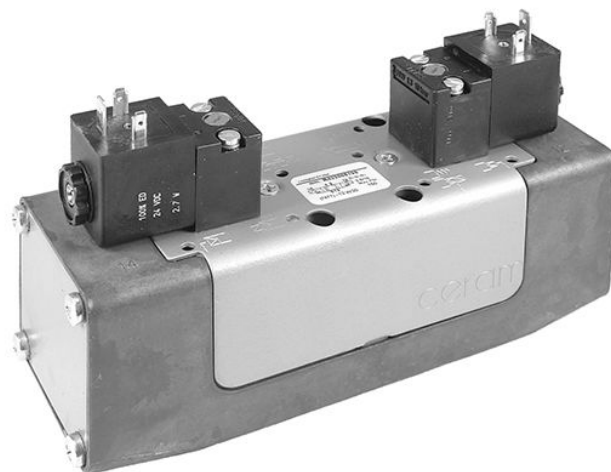

Technical data

Industry
Industrial

Activation
Electrically

Nominal flow Qn
7500 l/min

Switching principle
5/3

Version
Exhausted Center

Working pressure min.
0 bar

Working pressure max
10.3 bar

Electrical connection type
Plug

Electrical connection size
EN 175301-803, form A

Actuating control
Single Solenoid

Sealing principle
Soft Seal

Pilot
External

Standards
ISO 5599-1

Pilot valve width
30 mm CNOMO

Frame size
ISO 4

basic valve with electrical connector
Basic valve without coil

Valve plug connector
Without valve plug connector

Control pressure min.
-0.8 bar

Control pressure max.
10.3 bar

Min. ambient temperature
-15 °C

Max. ambient temperature
66 °C

Standard compressed air connection
according to ISO 5599-1

Pilot valve width
30 mm CNOMO

Protection class according to NEMA
NEMA 4

mounting screws
M8 with hexagon socket

Material

Housing material
Die-cast aluminum

Surface housing
painted gray

Connection type
Plate connection

Blocking principle
Single base plate principle

Can be assembled into blocks
Can be assembled into blocks

Min. medium temperature
-15 °C

Max. medium temperature
66 °C

Medium
Compressed air

Compressed air connection pilot exhaust
Base plate ISO 5599-1

Mounting screw tightening torque
2.2 Nm

Weight
2.46 kg

Part No.
R432002460

Technical information

The min. control pressure must be adhered to, since otherwise faulty switching and valve failure may result!

The pressure dew point must be at least 15 °C under ambient and medium temperature and may not exceed 3 °C .

The oil content of compressed air must remain constant during the life cycle.

Use only the approved oils from AVENTICS. Further information can be found in the “Technical information” document (available in <https://www.emerson.com/en-us/support>).

Dimensions in inches

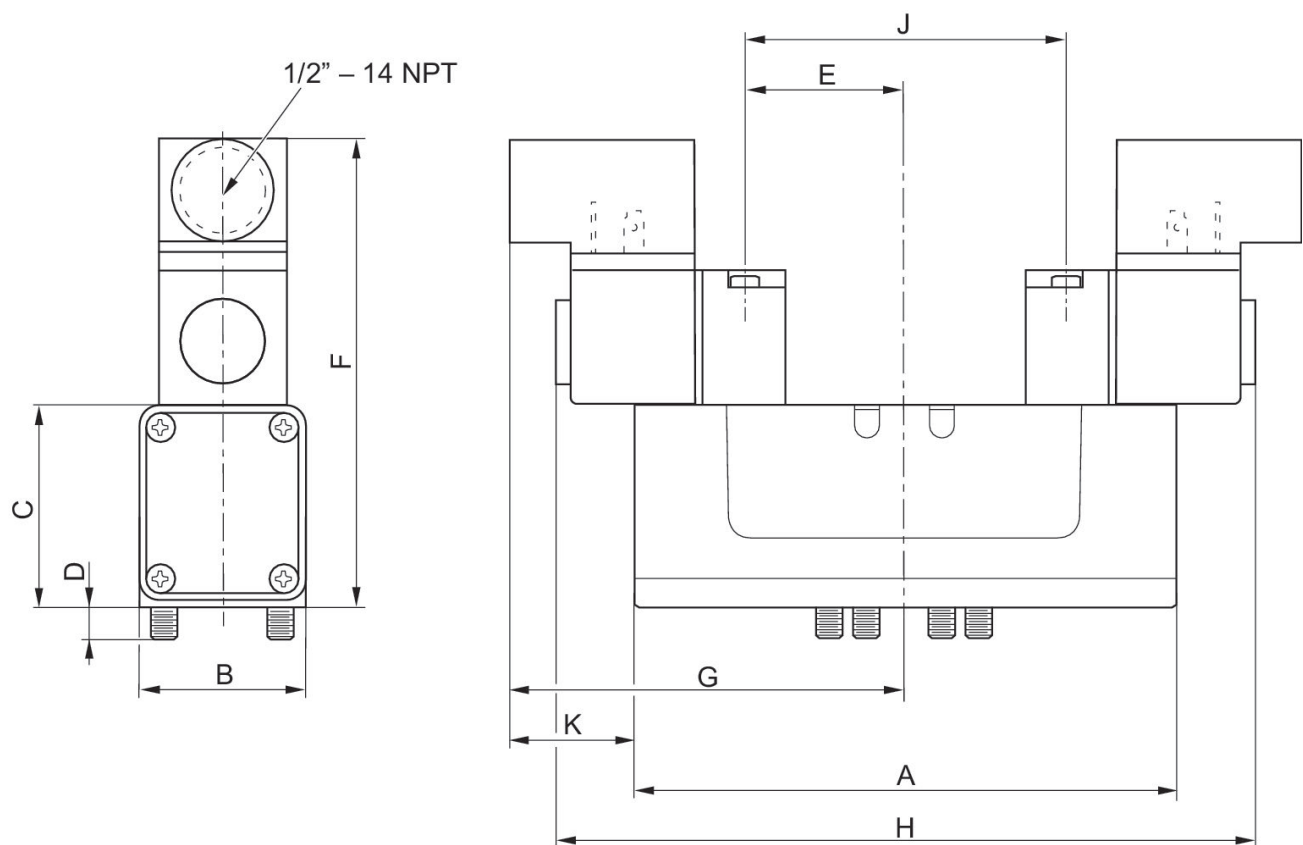

Dimensions in inches

Part No.	A	B	C	D	E	F	G	H	J
R432002460	8.62	3.09	2.89	0.41	1.62	5.32	6.65	13.31	3.25
R432029042	8.62	3.09	2.89	0.41	1.62	5.32	6.65	13.31	3.25
R432006284	8.62	3.09	2.89	0.41	1.62	5.32	6.65	13.31	3.25
R432030339	8.62	3.09	2.89	0.41	1.62	5.32	6.65	13.31	3.25

Part No.	A	B	C	D	E	F	G	H	J
R432006283	8.62	3.09	2.89	0.41	1.62	5.32	6.65	13.31	3.25
R432030340	8.62	3.09	2.89	0.41	1.62	5.32	6.65	13.31	3.25
R432002462	8.62	3.09	2.89	0.41	1.62	5.32	6.65	13.31	3.25

K
0.68
0.68
0.68
0.68
0.68
0.68
0.68

Blanking plate

- standard ISO 5599-1

- Frame size ISO 1 ISO 2 ISO 3 ISO 4



Standards	ISO 5599-1
Working pressure min./max.	-1 ... 16 bar
Ambient temperature min./max.	-20 ... 70 °C
Medium temperature min./max.	-20 ... 70 °C
Medium	Compressed air
Number of valve positions max.	1
Weight	See table below

Technical data

Part No.	Frame size	Weight
5801870000	ISO 1	0.055 kg
5802870000	ISO 2	0.1 kg
5803870000	ISO 3	0.21 kg
5804870000	ISO 4	0.27 kg

Scope of delivery incl. seal and mounting screws

Technical information

The min. control pressure must be adhered to, since otherwise faulty switching and valve failure may result!

The pressure dew point must be at least 15 °C under ambient and medium temperature and may not exceed 3 °C .

The oil content of compressed air must remain constant during the life cycle.

Use only the approved oils from AVENTICS. Further information can be found in the "Technical information" document (available in the MediaCentre).

Technical information

Material	
Housing	Die-cast aluminum, black painted
Base plate	Die-cast aluminum
Seal	Acrylonitrile butadiene rubber

Dimensions

Dimensions

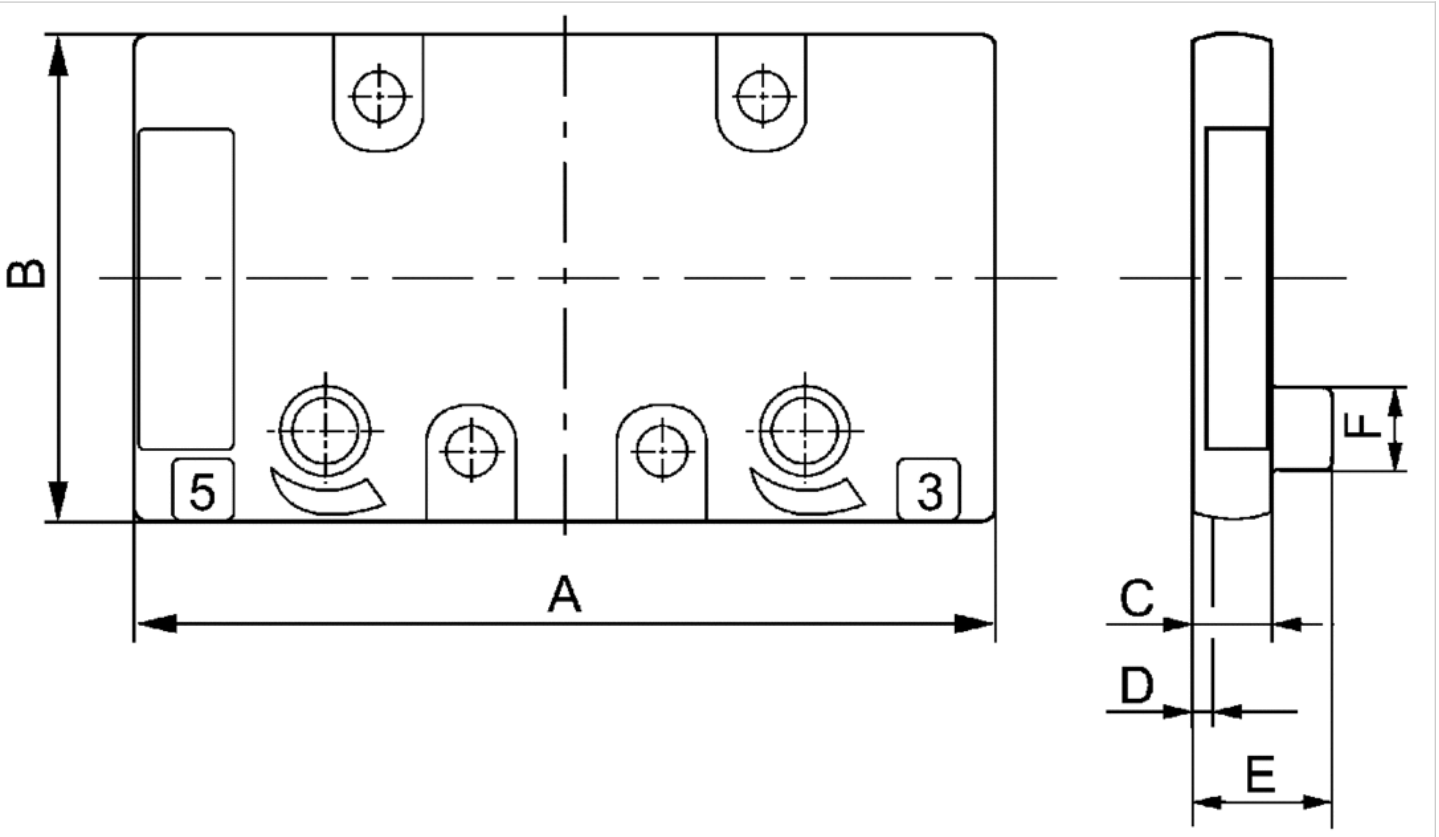

Dimensions

Part No.	A	B	C	D	E	F	Weight
5801870000	69	39	7	2	–	–	0.055 kg
5802870000	86.4	49.4	9	2	–	–	0.1 kg
5803870000	116.5	63.5	10	2	15	12	0.21 kg
5804870000	142.5	74.5	10	2	20	15	0.27 kg

Pressure regulator for vertical stacking



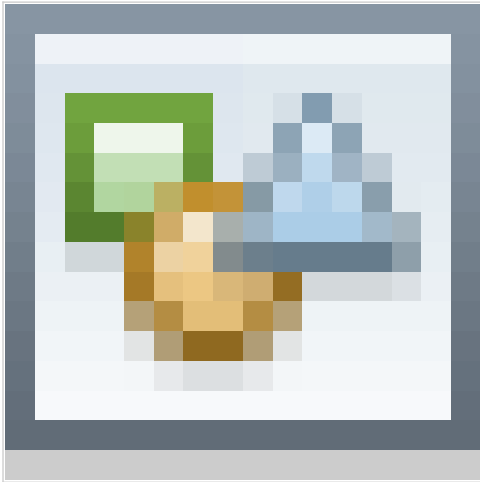





- standard ISO 5599-1
- Frame size ISO 1
- Controlled port 1 2 4 2, 4



Working pressure min./max.	16 bar
Adjustment range min./max.	0.5 ... 12 bar
Ambient temperature min./max.	5 ... 50 °C
Medium	Compressed air
Max. particle size	5 µm
Oil content of compressed air	0 ... 5 mg/m ³
Weight	See table below

The delivered product may vary from that in the illustration.

Technical data

Part No.		Frame size	Controlled port	Weight	Fig.	
0821302048		ISO 1	1	1.15 kg	Fig. 1	1)
0821302060		ISO 1	1	1.19 kg	Fig. 1	2)
0821302054		ISO 1	2	1.15 kg	Fig. 1	1)
0821302062		ISO 1	2	1.19 kg	Fig. 1	2)
0821302057		ISO 1	4	1.15 kg	Fig. 1	1)
0821302063		ISO 1	4	1.19 kg	Fig. 1	2)
0821302051		ISO 1	2, 4	1.57 kg	Fig. 2	1)
0821302061		ISO 1	2, 4	1.61 kg	Fig. 2	2)

Scope of delivery incl. seal and mounting screws, pressure regulator without gauge adapter, cannot be combined with IS12 ISO valves

- 1) with pressure gauge
- 2) with pressure gauge and adapter

Technical information

Material	
Housing	Zinc
Seals	Butadiene rubber

Dimensions

Fig. 1

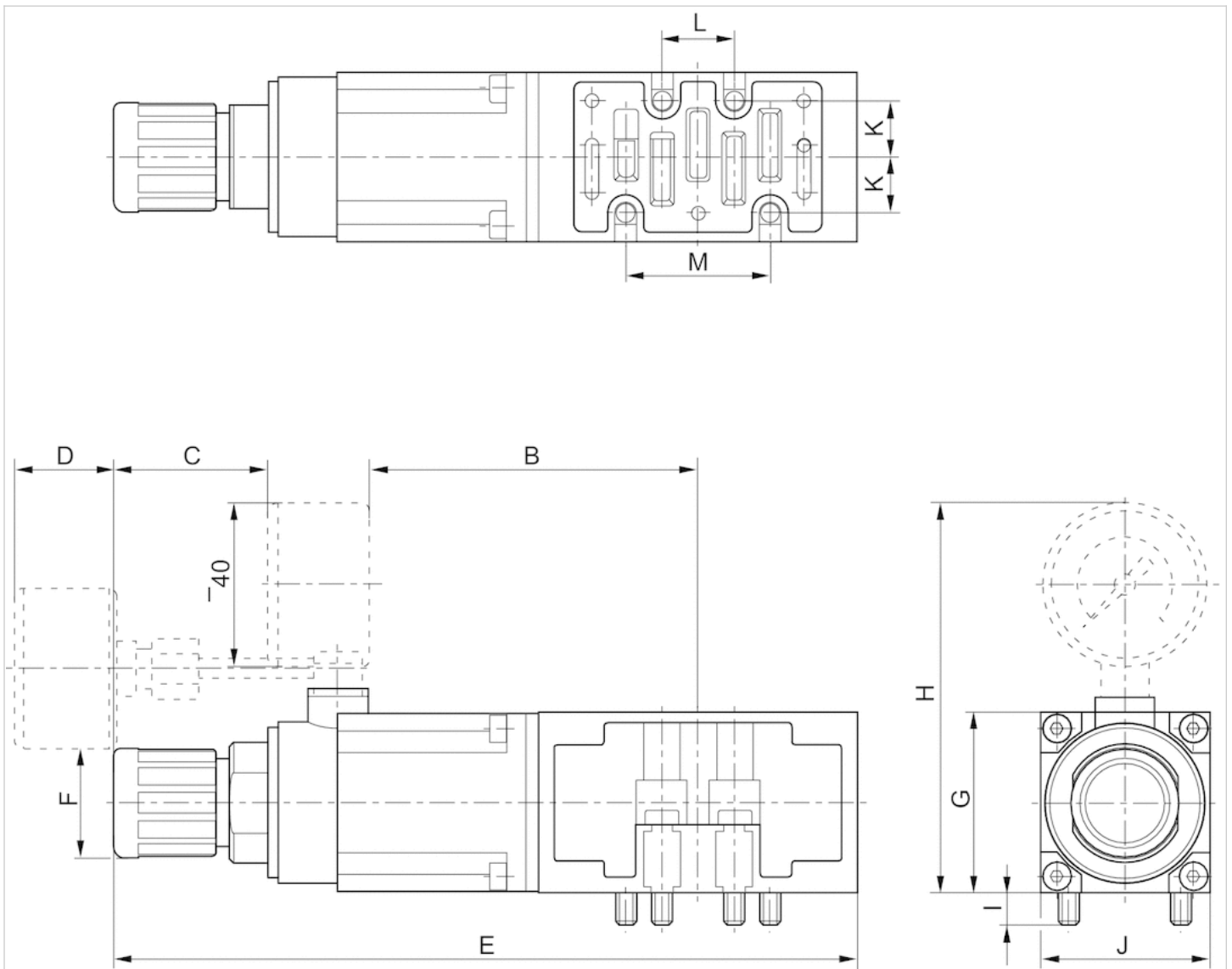

Dimensions

Part No.	B±5	C±5	D±5	E±7	Ø F	G±5	H±5	I±2.5	J±5	K±2.5	L±2.5	M±5
0821302048	82	38,6	—	186	27	45	97,5	8	42.5	14	18	36
0821302060	—	—	25	186	27	45	97,5	8	42.5	14	18	36
0821302054	82	38,5	—	199	27	45	97,5	8	42.5	14	18	36
0821302062	—	—	25	199	27	45	97,5	8	42.5	14	18	36

Dimensions

Fig. 2

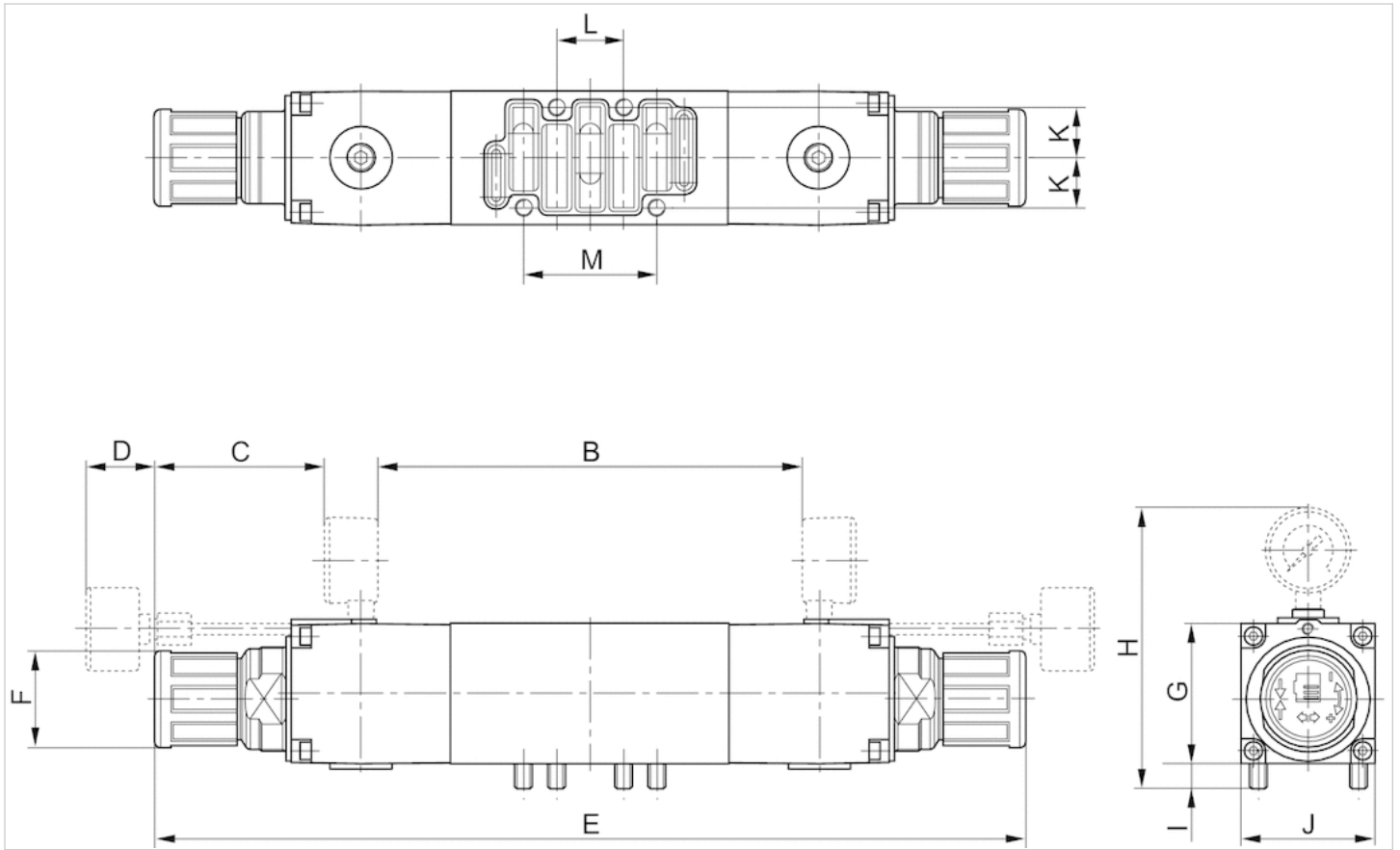

Dimensions

Part No.	B±5	C±5	D±5	E±7	Ø F	G±5	H±5	I±2.5	J±5	K±2.5	L±2.5	M±5
0821302051	164	38,6	—	292	27	45	96,5	8	42.5	14	18	36
0821302061	—	—	25	292	27	45	—	8	42.5	14	18	36

Diagrams

Flow rate characteristic

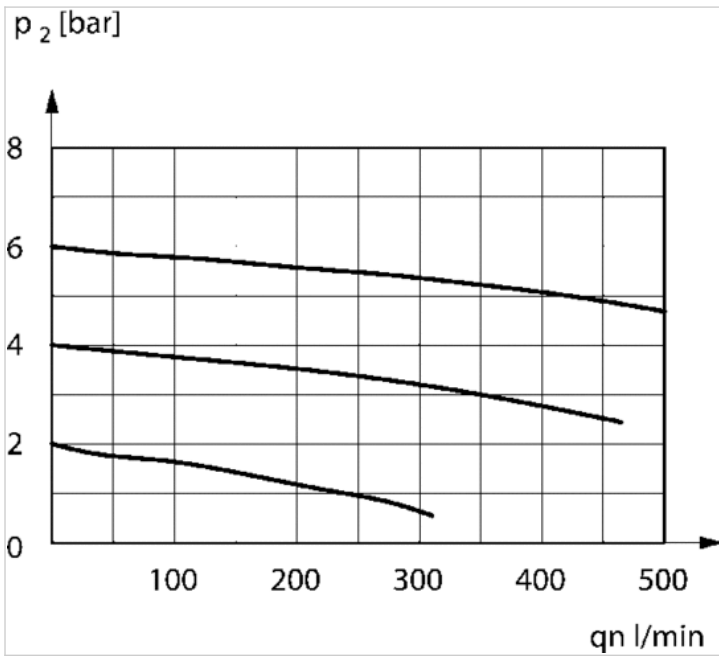

controlled connection 1
 Controlled connection 2
 Controlled connection 4

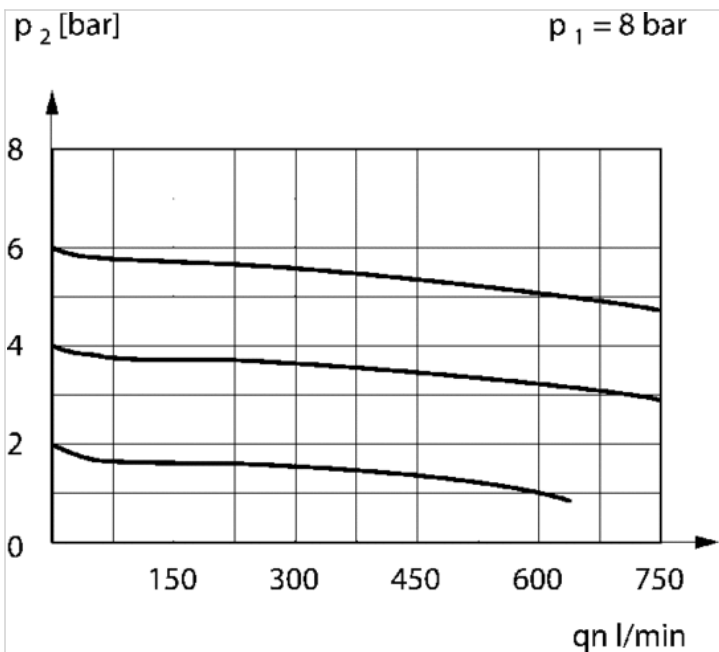

Controlled connection 2/4

Valve plug connector, series CON-VP

- Socket, 2+E, angled, 90° Socket, 3+E, angled, 90°

- EN 175301-803

- unshielded

- with LED Yellow Red Green green/red



Connection type	Screws
Ambient temperature min./max.	-40 ... 90 °C
Operational voltage	See table below
Protection class	IP65
Mounting screw tightening torque	0.4 Nm
Weight	See table below

Technical data

Part No.	Electrical connection	Operational voltage	Max. current
1834484048	Socket 2+E angled 90°	-	10 A
1834484059	Socket 3+E angled 90°	-	10 A
1834484101	Socket 2+E angled 90°	24 V AC/DC	-
1834484102	Socket 2+E angled 90°	110 V AC	-
1834484103	Socket 2+E angled 90°	230 V AC	-
8941016112	Socket 2+E angled 90°	230 V AC	-
8941012462	Socket 3+E angled 90°	24 V DC	8 A

Part No.	Protective circuit	Contact assignment	LED status display	suitable cable-Ø min./max
1834484048	-	2+E	-	6 / 8 mm
1834484059	-	3+E	-	6 / 8 mm
1834484101	Z-diode	2+E	Yellow	6 / 8 mm
1834484102	Varistor	2+E	Red	6 / 8 mm
1834484103	Varistor	2+E	Red	6 / 8 mm
8941016112	Varistor	2+E	Green	6 / 10 mm
8941012462	-	3+E	green/red	4.5 / 11 mm

Part No.	Seal	Weight	
1834484048	caoutchouc/butadiene caoutchouc	0.03 kg	1)
1834484059	caoutchouc/butadiene caoutchouc	0.03 kg	1)
1834484101	Silicone caoutchouc	0.03 kg	2)
1834484102	caoutchouc/butadiene caoutchouc	0.03 kg	1)
1834484103	Silicone caoutchouc	0.025 kg	1)
8941016112	caoutchouc/butadiene caoutchouc	0.03 kg	1)
8941012462	caoutchouc/butadiene caoutchouc	0.03 kg	2)

- 1) Profile seal
- 2) Flat gasket

Technical information

The specified protection class is only valid in assembled and tested state.

Technical information

Material

Seals	caoutchouc/butadiene caoutchouc Silicone caoutchouc
-------	-----------------------------------------------------

Dimensions

Dimensions

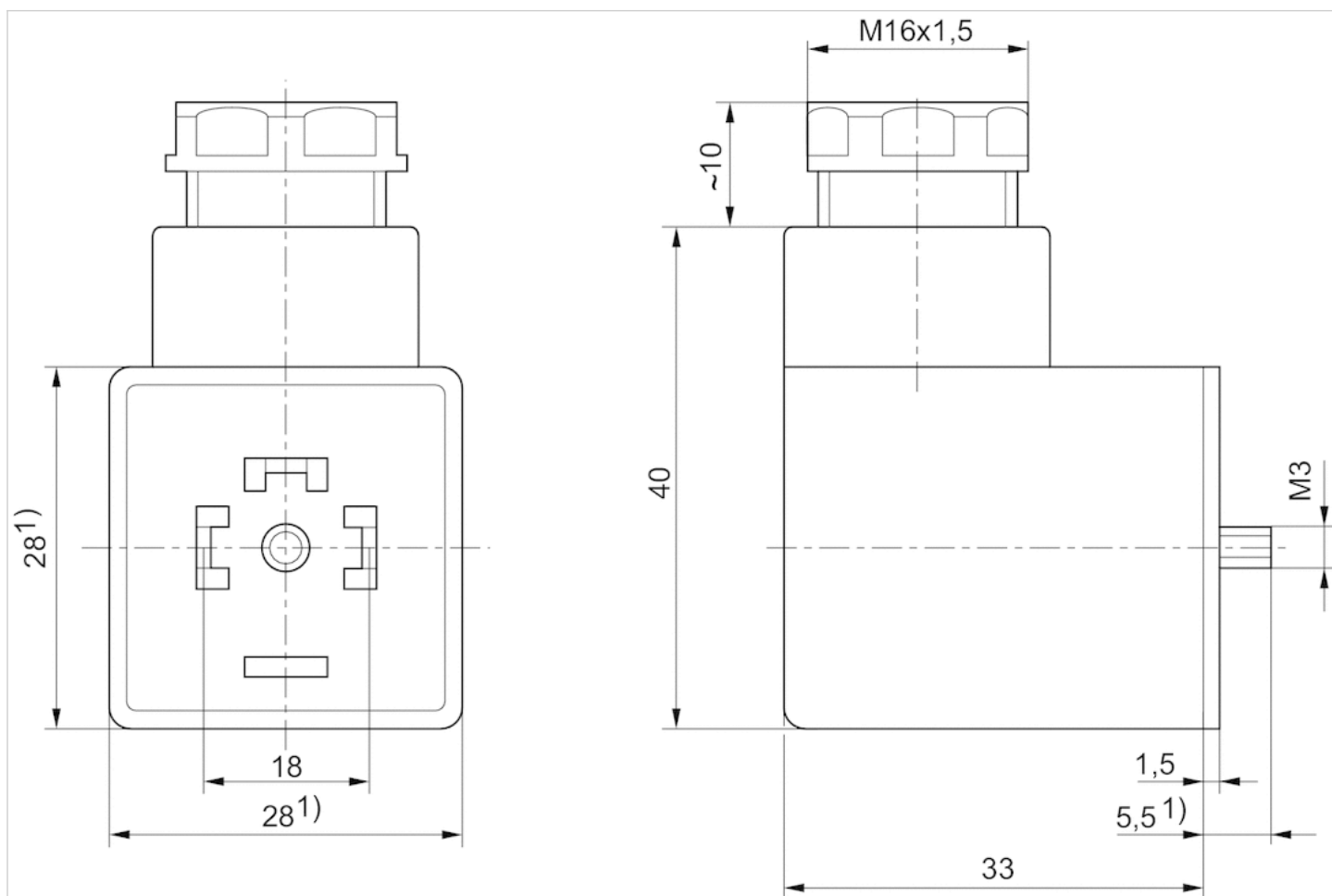

1) Max.





Valve plug connector, series CON-VP

- Socket form A 2+E angled 90°
- open cable ends 3-pin
- with cable
- unshielded

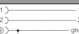

Ambient temperature min./max.	-20 ... 80 °C
Operational voltage	See table below
Protection class	IP67
Wire cross-section	0.75 mm ²
Mounting screw tightening torque	0.4 Nm
Weight	See table below

Technical data

Part No.		Operational voltage	Protective circuit	Contact assignment	LED status display
1834484160		230 V AC/DC	-	2+E	-
1834484162		24 V AC/DC	Z-diode	2+E	Yellow
1834484163		24 V AC/DC	Z-diode	2+E	Yellow
1834484164		230 V AC/DC	Varistor	2+E	Red
1834484165		230 V AC/DC	Varistor	2+E	Red

Part No.	Number of wires	Cable-Ø	Cable length	Weight	Fig.	
1834484160	3	5.9 mm	3 m	0.2 kg	Fig. 1	1)
1834484162	3	5.9 mm	3 m	0.2 kg	Fig. 2	-
1834484163	3	5.9 mm	5 m	0.31 kg	Fig. 2	-
1834484164	3	5.9 mm	3 m	0.2 kg	Fig. 2	-
1834484165	3	5.9 mm	5 m	0.31 kg	Fig. 2	-

1) Scope of delivery incl. flat gasket

Technical information

The specified protection class is only valid in assembled and tested state.

Technical information

Material	
Seals	caoutchouc/butadiene caoutchouc
Cable sheath	Polyvinyl chloride

Dimensions

Fig. 1

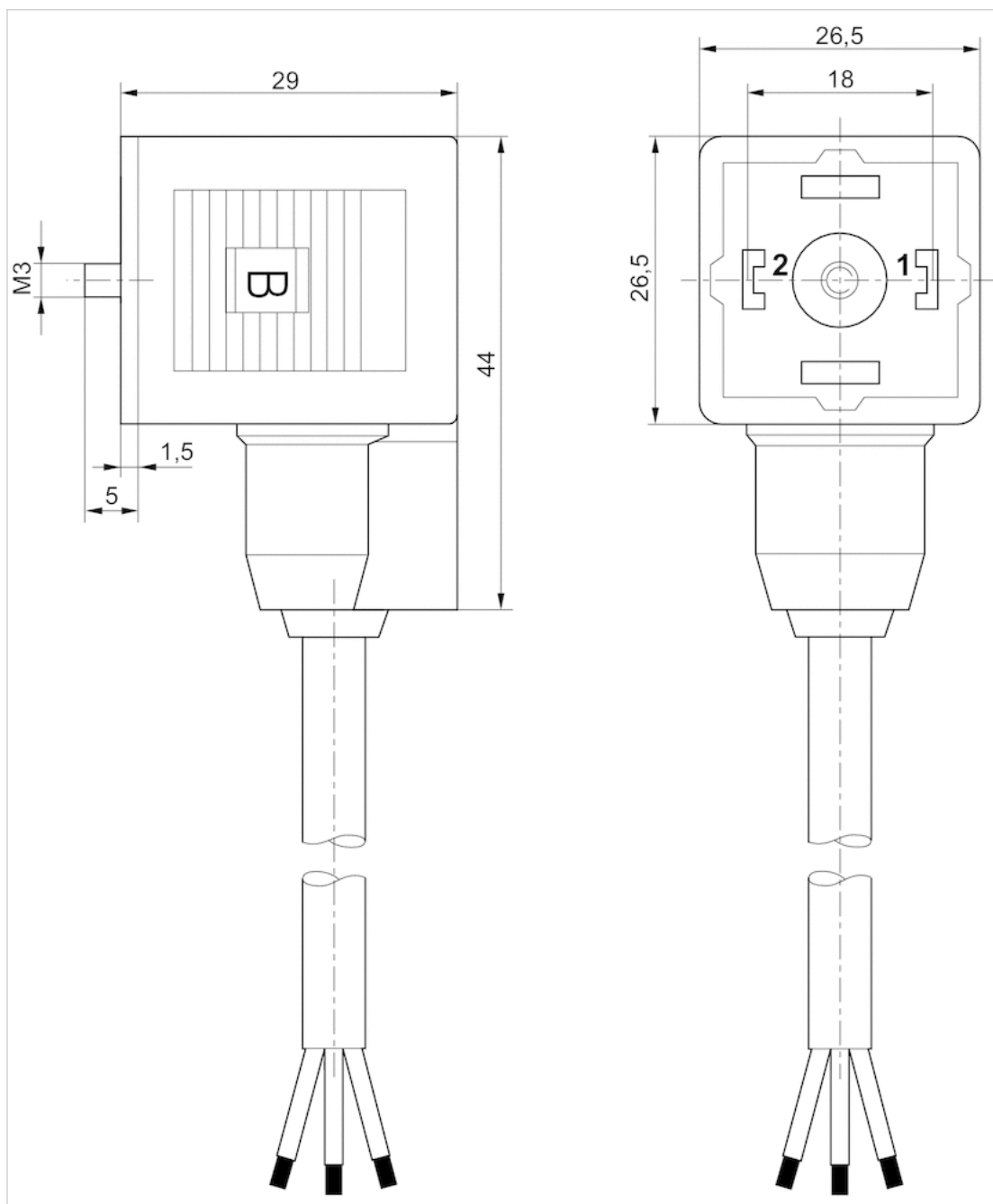
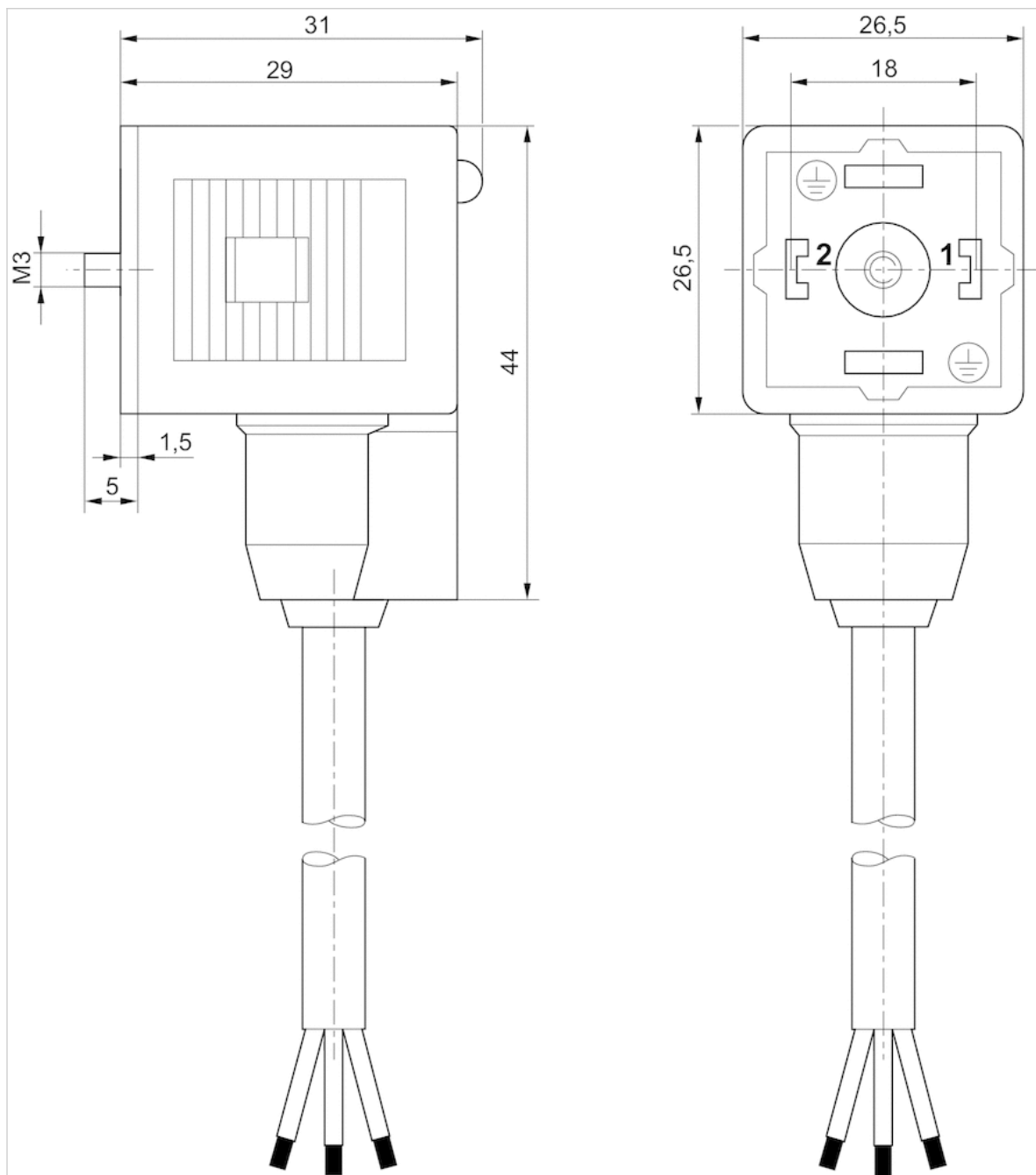

Fig. 2



Coil, Series CO1

R432011985

Coils, Series CO1

- Coil widths 15, 22 and 30 mm
- Electr. control: M8, form A, form B, form BI, form C
- ATEX optional

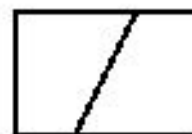

Technical data

Industry
Industrial

Coil width
30 mm

Max. ambient temperature
50 °C

Connector standard
EN 175301-803, form A

Protection class
IP65

Duty cycle ED
100 %

Compatibility index
14

Electrical connection 2
Plug

Number of poles
3-pin

Operational voltage AC at 50 Hz
110 V

Operational voltage AC at 60 Hz
110 V

Voltage tolerance DC
-10% / +10%

Holding power AC 50 Hz
3.7 VA

Holding power AC 60 Hz
3.7 VA

Weight
0.096 kg

Material

Housing
Thermoplastic elastomer

Part No.
R432011985

Technical information

Dimensions

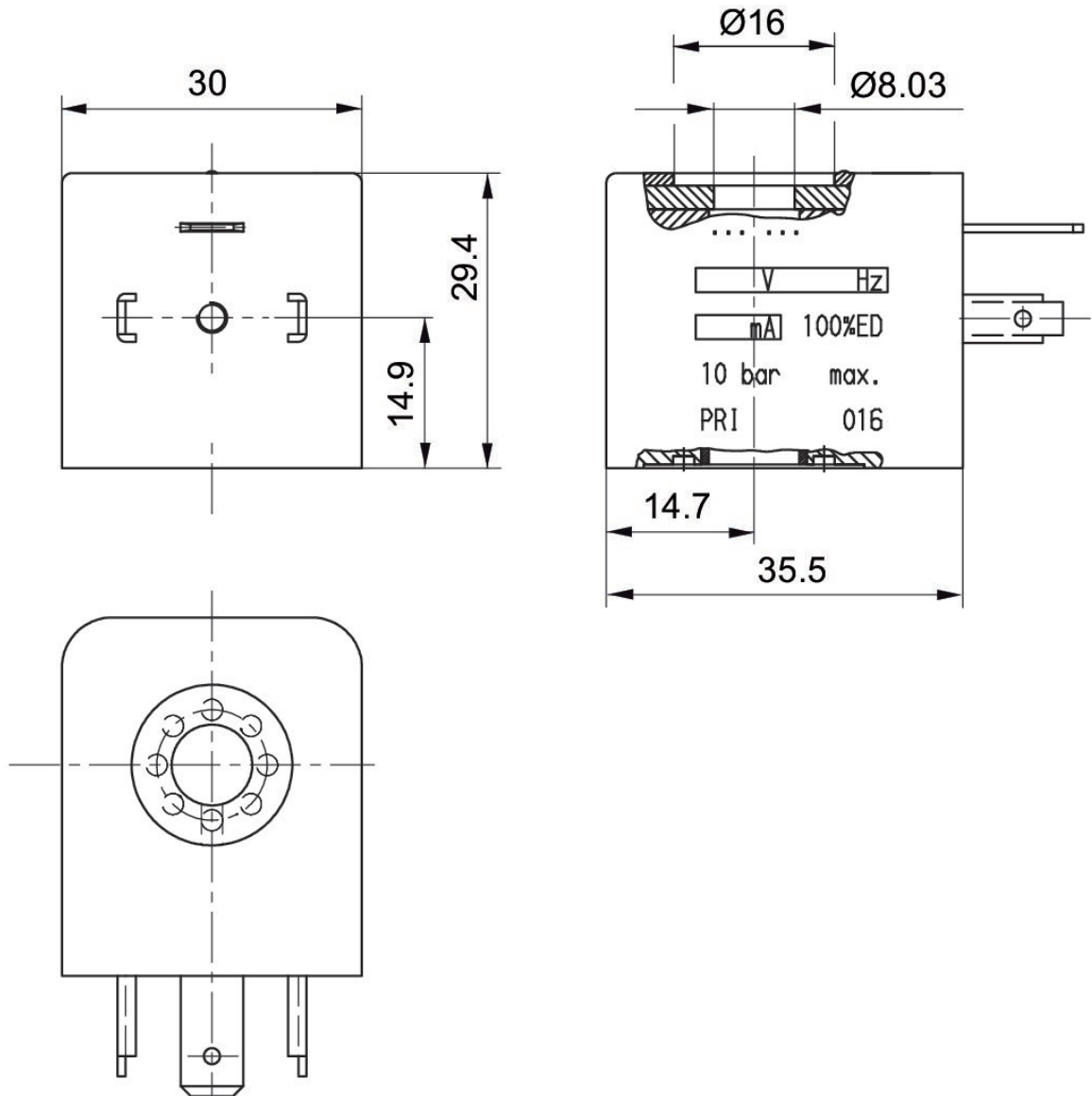

Coil, Series CO1

R432011986

Coils, Series CO1

- Coil widths 15, 22 and 30 mm
- Electr. control: M8, form A, form B, form BI, form C
- ATEX



Technical data

Industry
Industrial

Coil width
30 mm

Max. ambient temperature
50 °C

Connector standard
EN 175301-803, form A

Protection class
IP65

Duty cycle ED
100 %

Compatibility index
14

Electrical connection 2
Plug

Number of poles
3-pin

Operational voltage AC at 50 Hz
220 V

Operational voltage AC at 60 Hz
220 V

Voltage tolerance DC
-10% / +10%

Holding power AC 50 Hz
3.7 VA

Holding power AC 60 Hz
3.7 VA

Weight
0.096 kg

Material

Housing
Thermoplastic elastomer

Part No.
R432011986

Technical information

Dimensions

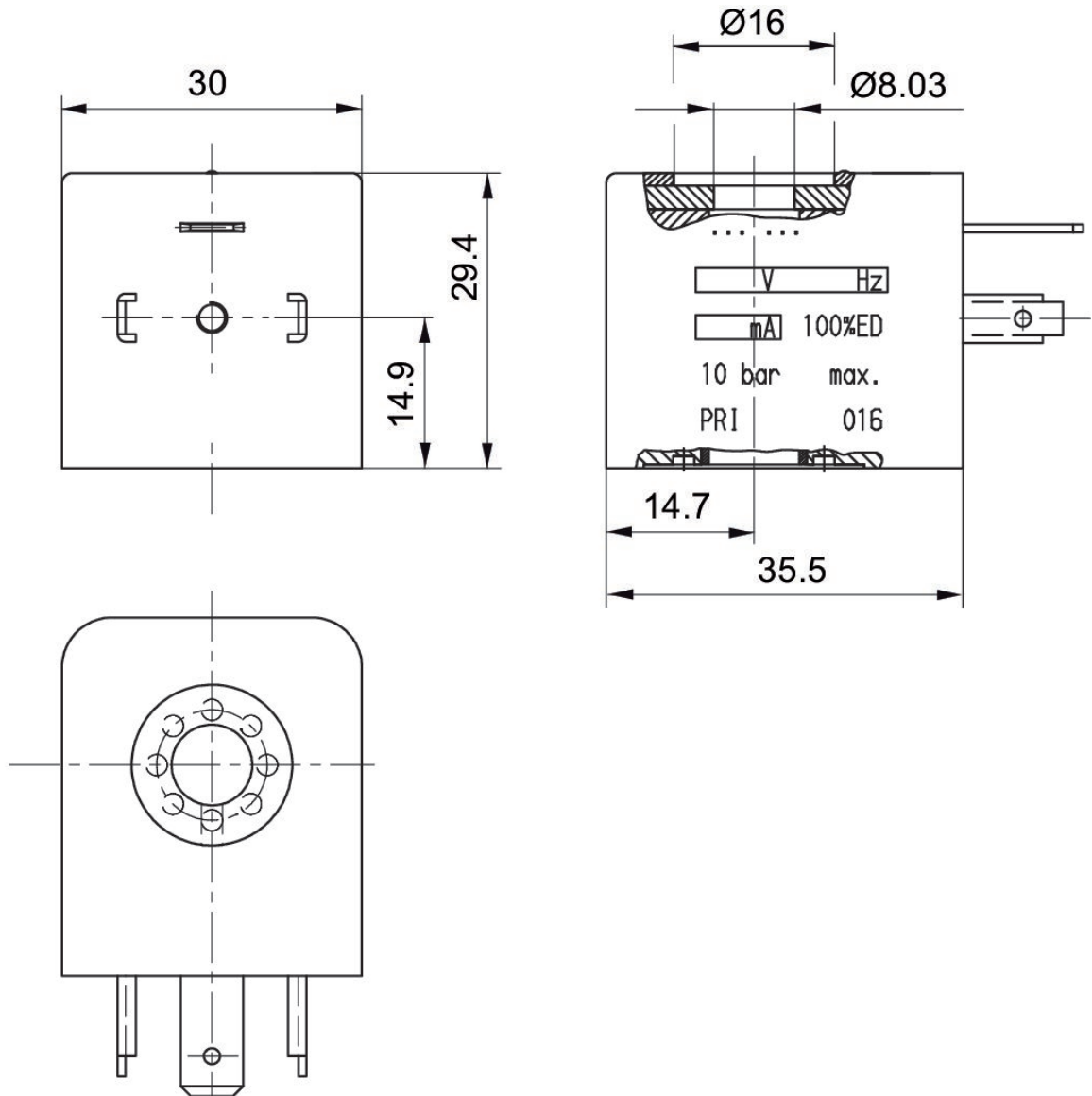

Coil, Series CO1

R432011989

Coils, Series CO1

- Coil widths 15, 22 and 30 mm
- Electr. control: M8, form A, form B, form BI, form C
- ATEX optional



Technical data

Industry
Industrial

Coil width
30 mm

Max. ambient temperature
50 °C

Connector standard
EN 175301-803, form A

Protection class
IP65

Duty cycle ED
100 %

Compatibility index
14

Electrical connection 2
Plug

Number of poles
3-pin

DC operating voltage
24 V

Voltage tolerance DC
-10% / +10%

Power consumption DC
2.7 W

Weight
0.096 kg

Material

Housing
Thermoplastic elastomer

Part No.
R432011989

Technical information

Dimensions

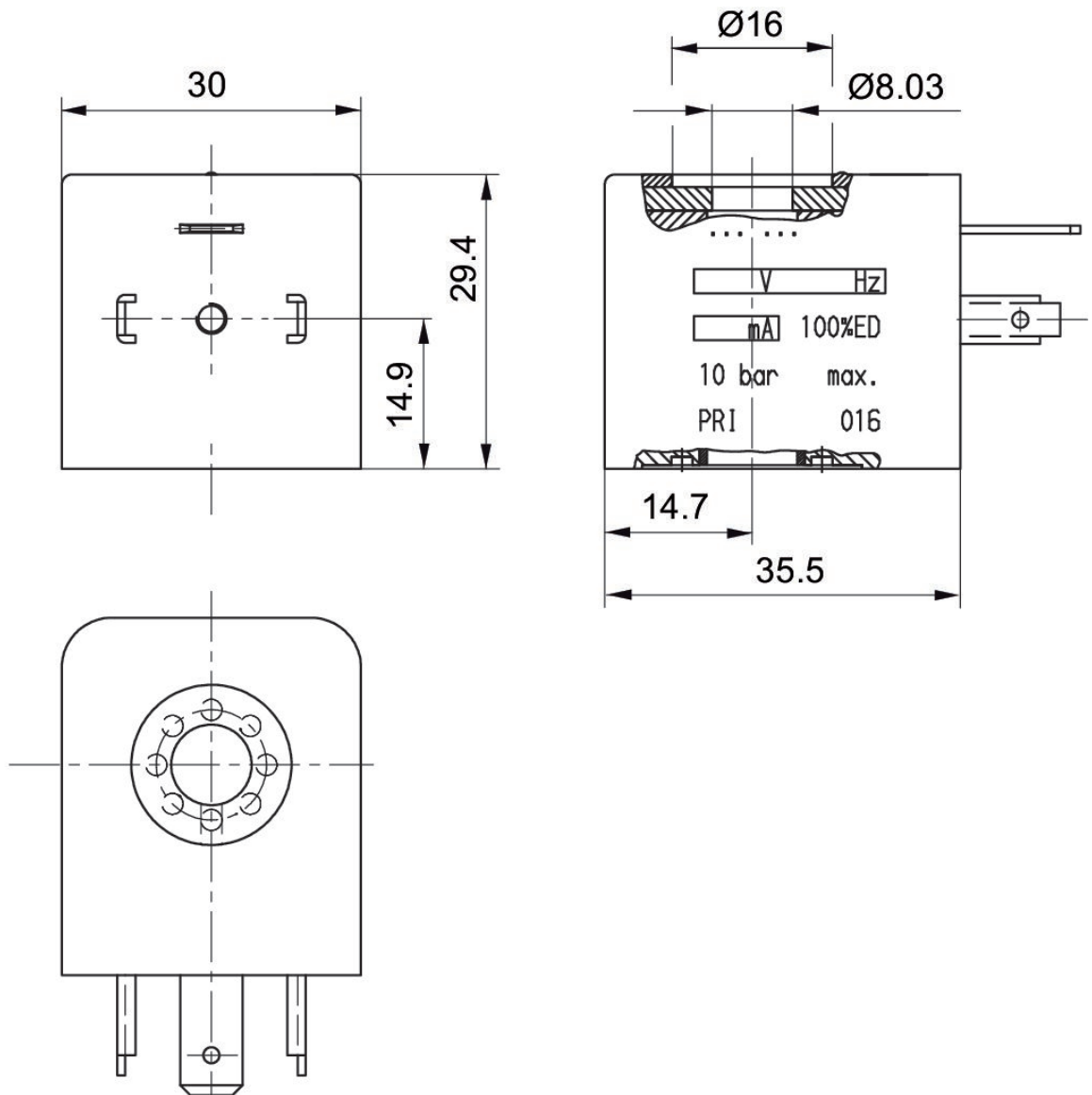

Coil, Series CO1

R432011990

Coils, Series CO1

- Coil widths 15, 22 and 30 mm
- Electr. control: M8, form A, form B, form BI, form C
- ATEX optional



Technical data

Industry
Industrial

Coil width
30 mm

Max. ambient temperature
50 °C

Connector standard
EN 175301-803, form A

Protection class
IP65

Duty cycle ED
100 %

Compatibility index
14

Electrical connection 2
Plug

Number of poles
3-pin

Operational voltage AC at 50 Hz
24 V

Operational voltage AC at 60 Hz
24 V

Voltage tolerance DC
-10% / +10%

Holding power AC 50 Hz
3.7 VA

Holding power AC 60 Hz
3.7 VA

Weight
0.096 kg

Material

Housing
Thermoplastic elastomer

Part No.
R432011990

Technical information

Dimensions

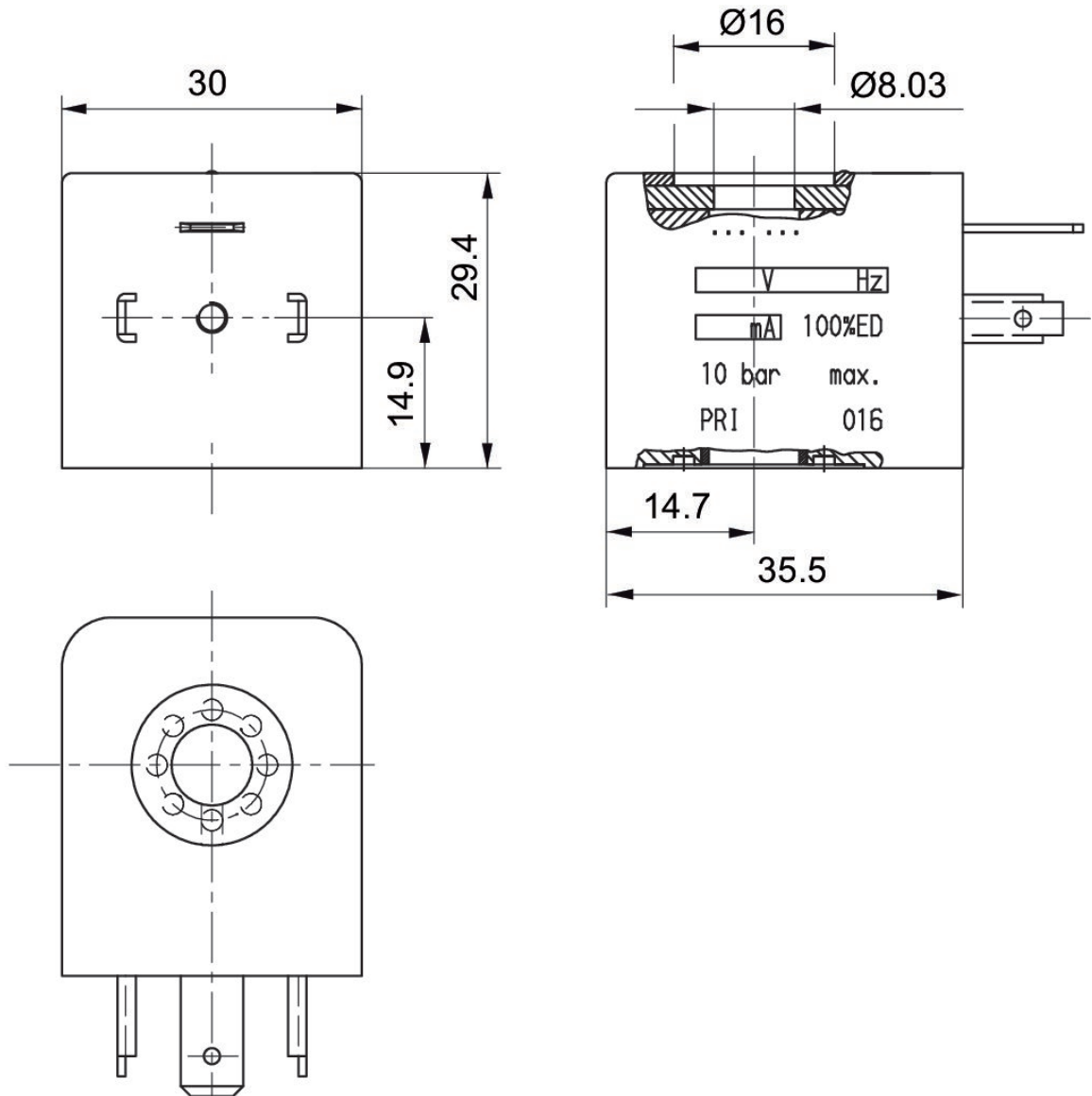

Efficient pneumatic solutions, our program: cylinders and drives, valves and valve systems, air supply management



Visit us: Emerson.com/Aventics

Your local contact: Emerson.com/contactus



Emerson.com



Facebook.com/EmersonAutomationSolutions



LinkedIn.com/company/Emerson-Automation-Solutions



Twitter.com/EMR_Automation

An example configuration is depicted on the title page. The delivered product may thus vary from that in the illustration. Subject to change. This Document, as well as the data, specifications and other information set forth in it, are the exclusive property of AVENTICS GmbH. It may not be reproduced or given to third parties without its consent. Only use the AVENTICS products shown in industrial applications. Read the product documentation completely and carefully before using the product. Observe the applicable regulations and laws of the respective country. When integrating the product into applications, note the system manufacturer's specifications for safe use of the product. The data specified only serve to describe the product. No statements concerning a certain condition or suitability for a certain application can be derived from our information. The information given does not release the user from the obligation of own judgment and verification. It must be remembered that the products are subject to a natural process of wear and aging.

The Emerson logo is a trademark and service mark of Emerson Electric Co. Brand logotype are registered trademarks of one of the Emerson family of companies. All other marks are the property of their respective owners. © 2017 Emerson Electric Co. All rights reserved.
2019-03



CONSIDER IT SOLVED™